

+ GENEL RULMAN KATALOĞU

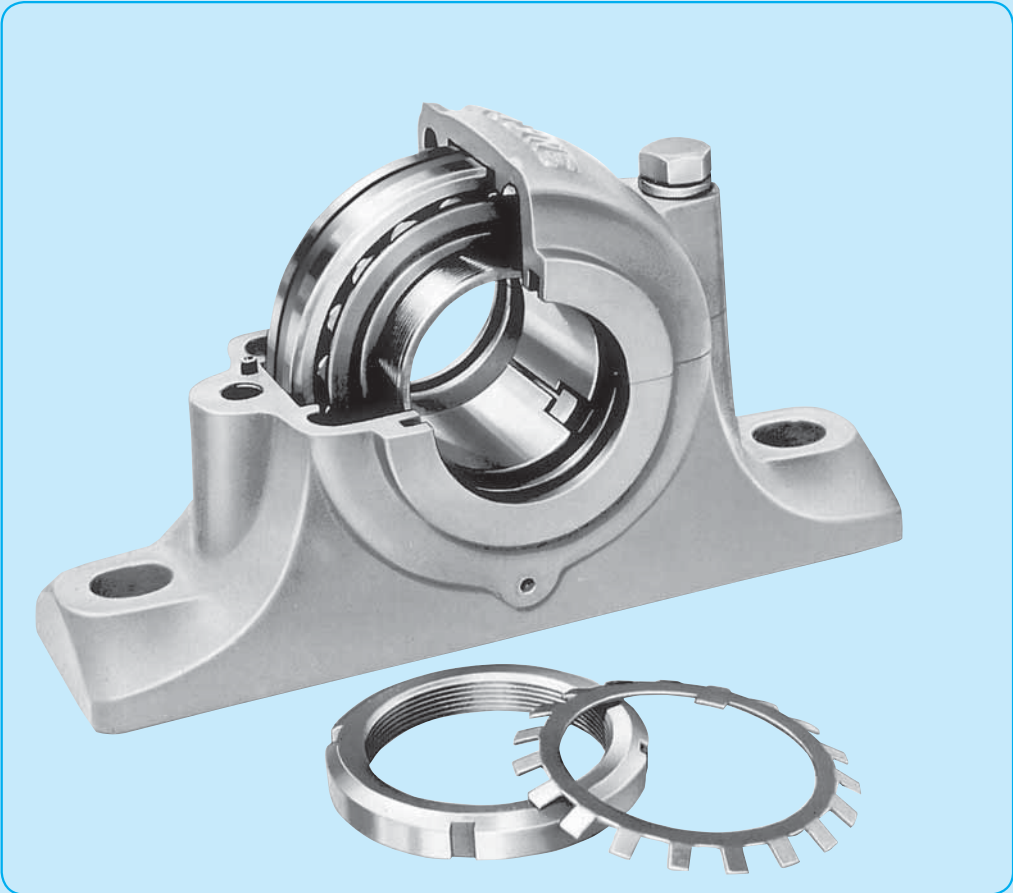



RULMANLARIN AKSESUARLARI

| | | |
|-------------------------------------|---------------------------|------|
| RULMANLARIN ADAPTÖRLERİ | Mil Çapı 17 – 470mm | B358 |
| RULMANLARIN ÇEKME MANŞONLARI | Mil Çapı 35 – 480mm | B366 |
| RULMANLARIN SOMUNLARI | | B372 |
| RULMANLARIN STOPERLERİ | | B377 |
| RULMANLARIN PULLARI | | B378 |

RULMANLARIN ADAPTÖRLERİ

Mil Çapı 17 – 40 mm

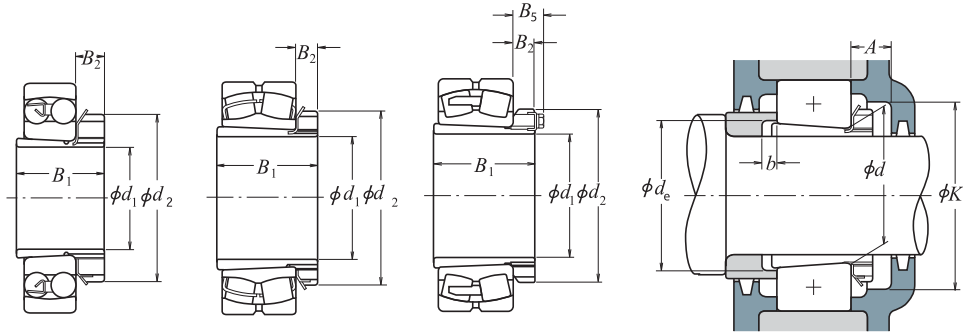

| Mil Çapı (mm) | Nominal Rulman Delik Çapı (mm) | Nominal Numaralar | | Ölçüler (mm) | | | | Adaptör Manşonu Numaraları | Dayanak Ölçüleri (mm) | | | | Kütle (kg) |
|------------------|---|-------------------|----------|-----------------|----------------|----------------|----------------|----------------------------------|--------------------------|-----------|------------------------|-----------|---------------|
| | | Mevcut Rulmanlar | | B ₁ | d ₂ | B ₂ | B ₃ | | A min. | K min. | d _e min. | b min. | |
| 17 | 20 | 1204K | + H 204X | 24 | 32 | 7 | — | A 204X | 14 | 39 | 23 | 5 | 0.045 |
| | 20 | 2204K | + H 304X | 28 | 32 | 7 | — | A 304X | 14 | 39 | 24 | 5 | 0.045 |
| | 20 | 1304K | + H 304X | 28 | 32 | 7 | — | A 304X | 14 | 39 | 24 | 8 | 0.045 |
| | 20 | 2304K | + H2304X | 31 | 32 | 7 | — | A2304X | 14 | 39 | 24 | 5 | 0.050 |
| 20 | 25 | 1205K | + H 205X | 26 | 38 | 8 | — | A 205X | 15 | 45 | 28 | 5 | 0.065 |
| | 25 | 2205K | + H 305X | 29 | 38 | 8 | — | A 305X | 15 | 45 | 29 | 5 | 0.075 |
| | 25 | 1305K | + H 305X | 29 | 38 | 8 | — | A 305X | 15 | 45 | 29 | 6 | 0.075 |
| | 25 | 21305C DKE4 | + H 305X | 29 | 38 | 8 | — | A 305X | 15 | 45 | 29 | 6 | 0.075 |
| | 25 | 2305K | + H2305X | 35 | 38 | 8 | — | A2305X | 15 | 45 | 29 | 5 | 0.090 |
| 25 | 30 | 1206K | + H 206X | 27 | 45 | 8 | — | A 206X | 15 | 50 | 33 | 5 | 0.10 |
| | 30 | 2206K | + H 306X | 31 | 45 | 8 | — | A 306X | 15 | 50 | 34 | 5 | 0.11 |
| | 30 | 1306K | + H 306X | 31 | 45 | 8 | — | A 306X | 15 | 50 | 34 | 6 | 0.11 |
| | 30 | 21306C DKE4 | + H 306X | 31 | 45 | 8 | — | A 306X | 15 | 50 | 34 | 6 | 0.11 |
| | 30 | 2306K | + H2306X | 38 | 45 | 8 | — | A2306X | 15 | 50 | 35 | 5 | 0.125 |
| 30 | 35 | 1207K | + H 207X | 29 | 52 | 9 | — | A 207X | 17 | 58 | 38 | 5 | 0.125 |
| | 35 | 2207K | + H 307X | 35 | 52 | 9 | — | A 307X | 17 | 58 | 39 | 5 | 0.145 |
| | 35 | 1307K | + H 307X | 35 | 52 | 9 | — | A 307X | 17 | 58 | 39 | 7 | 0.145 |
| | 35 | 21307C DKE4 | + H 307X | 35 | 52 | 9 | — | A 307X | 17 | 58 | 39 | 7 | 0.145 |
| | 35 | 2307K | + H2307X | 43 | 52 | 9 | — | A2307X | 17 | 58 | 40 | 5 | 0.16 |
| 35 | 40 | 1208K | + H 208X | 31 | 58 | 10 | — | A 208X | 17 | 65 | 44 | 5 | 0.175 |
| | 40 | 2208K | + H 308X | 36 | 58 | 10 | — | A 308X | 17 | 65 | 44 | 5 | 0.19 |
| | 40 | 1308K | + H 308X | 36 | 58 | 10 | — | A 308X | 17 | 65 | 44 | 5 | 0.19 |
| | 40 | 21308E AKE4 | + H 308X | 36 | 58 | 10 | — | A 308X | 17 | 65 | 44 | 5 | 0.19 |
| | 40 | 2308K | + H2308X | 46 | 58 | 10 | — | A2308X | 17 | 65 | 45 | 5 | 0.225 |
| | 40 | 22308E AKE4 | + H2308X | 46 | 58 | 10 | — | A2308X | 17 | 65 | 45 | 5 | 0.225 |
| 40 | 45 | 1209K | + H 209X | 33 | 65 | 11 | — | A 209X | 17 | 72 | 49 | 5 | 0.225 |
| | 45 | 2209K | + H 309X | 39 | 65 | 11 | — | A 309X | 17 | 72 | 49 | 8 | 0.26 |
| | 45 | 1309K | + H 309X | 39 | 65 | 11 | — | A 309X | 17 | 72 | 49 | 5 | 0.26 |
| | 45 | 21309E AKE4 | + H 309X | 39 | 65 | 11 | — | A 309X | 17 | 72 | 49 | 5 | 0.26 |
| | 45 | 2309K | + H2309X | 50 | 65 | 11 | — | A2309X | 17 | 72 | 50 | 5 | 0.30 |
| | 45 | 22309E AKE4 | + H2309X | 50 | 65 | 11 | — | A2309X | 17 | 72 | 50 | 5 | 0.30 |

Notlar X soneki, dar yarıklı adaptör manşonlarını temsil eder, bunlar için düz tırnaklı pullar kullanılmalıdır.

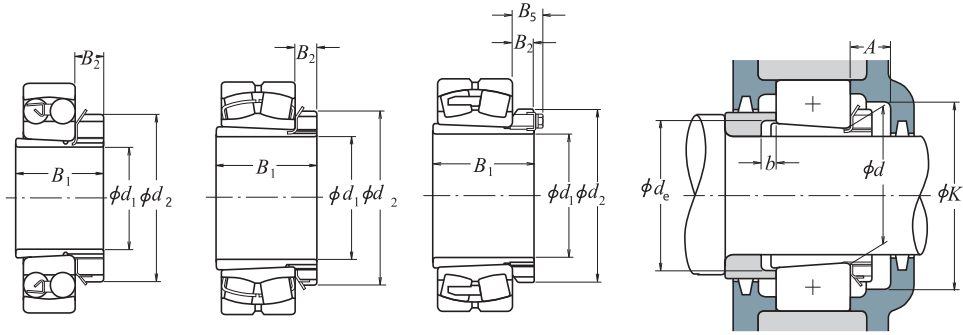

| Mil Çapı (mm) | Nominal Rulman Delik Çapı (mm) | Nominal Numaralar | | Ölçüler (mm) | | | | Adaptör Manşonu Numaraları | Dayanak Ölçüleri (mm) | | | | Kütle (kg) |
|---------------|--------------------------------|-------------------|----------|--------------|-------|-------|--------|----------------------------|-----------------------|----------|------------|----------|------------|
| | | | | B_1 | d_2 | B_2 | B_5 | | A min. | K min. | d_e min. | b min. | |
| 45 | 50 | 1210K | + H 210X | 35 | 70 | 12 | — | A 210X | 19 | 76 | 53 | 5 | 0.275 |
| | 50 | 2210K | + H 310X | 42 | 70 | 12 | — | A 310X | 19 | 76 | 54 | 10 | 0.30 |
| | 50 | 1310K | + H 310X | 42 | 70 | 12 | — | A 310X | 19 | 76 | 54 | 5 | 0.30 |
| 50 | 50 | 21310E AKE4 | + H 310X | 42 | 70 | 12 | — | A 310X | 19 | 76 | 54 | 5 | 0.30 |
| | 50 | 2310K | + H2310X | 55 | 70 | 12 | — | A2310X | 19 | 76 | 56 | 5 | 0.35 |
| | 50 | 22310E AKE4 | + H2310X | 55 | 70 | 12 | — | A2310X | 19 | 76 | 56 | 5 | 0.35 |
| 50 | 55 | 1211K | + H 211X | 37 | 75 | 12 | — | A 211X | 19 | 85 | 60 | 6 | 0.305 |
| | 55 | 2211K | + H 311X | 45 | 75 | 12 | — | A 311X | 19 | 85 | 60 | 11 | 0.35 |
| | 55 | 22211E AKE4 | + H 311X | 45 | 75 | 12 | — | A 311X | 19 | 85 | 60 | 11 | 0.35 |
| 50 | 55 | 1311K | + H 311X | 45 | 75 | 12 | — | A 311X | 19 | 85 | 60 | 6 | 0.35 |
| | 55 | 21311E AKE4 | + H 311X | 45 | 75 | 12 | — | A 311X | 19 | 85 | 60 | 6 | 0.35 |
| | 55 | 2311K | + H2311X | 59 | 75 | 12 | — | A2311X | 19 | 85 | 61 | 6 | 0.40 |
| 55 | 22311E AKE4 | + H2311X | 59 | 75 | 12 | — | A2311X | 19 | 85 | 61 | 6 | 0.40 | |
| 55 | 60 | 1212K | + H 212X | 38 | 80 | 13 | — | A 212X | 20 | 90 | 64 | 5 | 0.365 |
| | 60 | 2212K | + H 312X | 47 | 80 | 13 | — | A 312X | 20 | 90 | 65 | 9 | 0.40 |
| | 60 | 22212E AKE4 | + H 312X | 47 | 80 | 13 | — | A 312X | 20 | 90 | 65 | 9 | 0.40 |
| 55 | 60 | 1312K | + H 312X | 47 | 80 | 13 | — | A 312X | 20 | 90 | 65 | 5 | 0.40 |
| | 60 | 21312E AKE4 | + H 312X | 47 | 80 | 13 | — | A 312X | 20 | 90 | 65 | 5 | 0.40 |
| | 60 | 2312K | + H2312X | 62 | 80 | 13 | — | A2312X | 20 | 90 | 66 | 5 | 0.45 |
| 60 | 22312E AKE4 | + H2312X | 62 | 80 | 13 | — | A2312X | 20 | 90 | 66 | 5 | 0.45 | |
| 60 | 65 | 1213K | + H 213X | 40 | 85 | 14 | — | A 213X | 21 | 96 | 70 | 5 | 0.40 |
| | 65 | 2213K | + H 313X | 50 | 85 | 14 | — | A 313X | 21 | 96 | 70 | 8 | 0.45 |
| | 65 | 22213E AKE4 | + H 313X | 50 | 85 | 14 | — | A 313X | 21 | 96 | 70 | 8 | 0.45 |
| 60 | 65 | 1313K | + H 313X | 50 | 85 | 14 | — | A 313X | 21 | 96 | 70 | 5 | 0.45 |
| | 65 | 21313E AKE4 | + H 313X | 50 | 85 | 14 | — | A 313X | 21 | 96 | 70 | 5 | 0.45 |
| | 65 | 2313K | + H2313X | 65 | 85 | 14 | — | A2313X | 21 | 96 | 72 | 5 | 0.55 |
| 65 | 22313E AKE4 | + H2313X | 65 | 85 | 14 | — | A2313X | 21 | 96 | 72 | 5 | 0.55 | |
| 60 | 70 | 22214E AKE4 | + H 314X | 52 | 92 | 14 | — | A 314X | 21 | 96 | 70 | 8 | 0.65 |
| | 70 | 21314E AKE4 | + H 314X | 52 | 92 | 14 | — | A 314X | 21 | 96 | 70 | 5 | 0.65 |
| | 70 | 22314E AKE4 | + H2314X | 68 | 92 | 14 | — | A2314X | 21 | 96 | 72 | 5 | 0.80 |

Notlar X soneki, dar yarıklı adaptör manşonlarını temsil eder, bunlar için düz tırnaklı pullar kullanılmalıdır.

RULMANLARIN ADAPTÖRLERİ

Mil Çapı 65 – 80 mm

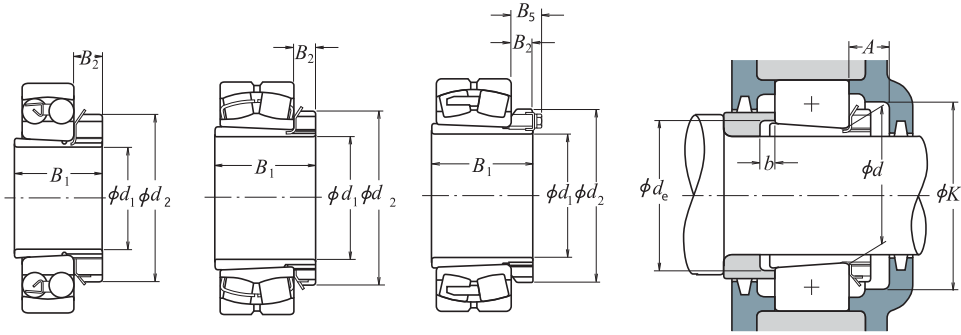

| Mil Çapı (mm) | Nominal Rulman Delik Çapı (mm) | Nominal Numaralar | | Ölçüler (mm) | | | | Adaptör Manşonlu Numaraları | Dayanak Ölçüleri (mm) | | | | Kütle (kg) |
|------------------|---|-------------------|----------|-----------------|-------|-------|-------|-----------------------------------|--------------------------|-------------|---------------|-------------|---------------|
| | | | | B_1 | d_2 | B_2 | B_3 | | A min. | K min. | d_c min. | b min. | |
| 65 | 75 | 1215K | + H 215X | 43 | 98 | 15 | — | A 215X | 23 | 110 | 80 | 5 | 0.70 |
| | 75 | 2215K | + H 315X | 55 | 98 | 15 | — | A 315X | 23 | 110 | 80 | 12 | 0.85 |
| | 75 | 22215E AKE4 | + H 315X | 55 | 98 | 15 | — | A 315X | 23 | 110 | 80 | 12 | 0.85 |
| | 75 | 1315K | + H 315X | 55 | 98 | 15 | — | A 315X | 23 | 110 | 80 | 5 | 0.85 |
| | 75 | 21315E AKE4 | + H 315X | 55 | 98 | 15 | — | A 315X | 23 | 110 | 80 | 5 | 0.85 |
| | 75 | 2315K | + H2315X | 73 | 98 | 15 | — | A2315X | 23 | 110 | 82 | 5 | 1.05 |
| | 75 | 22315E AKE4 | + H2315X | 73 | 98 | 15 | — | A2315X | 23 | 110 | 82 | 5 | 1.05 |
| 70 | 80 | 1216K | + H 216X | 46 | 105 | 17 | — | A 216X | 25 | 120 | 85 | 5 | 0.85 |
| | 80 | 2216K | + H 316X | 59 | 105 | 17 | — | A 316X | 25 | 120 | 86 | 12 | 1.05 |
| | 80 | 22216E AKE4 | + H 316X | 59 | 105 | 17 | — | A 316X | 25 | 120 | 86 | 12 | 1.05 |
| | 80 | 1316K | + H 316X | 59 | 105 | 17 | — | A 316X | 25 | 120 | 86 | 5 | 1.05 |
| | 80 | 21316E AKE4 | + H 316X | 59 | 105 | 17 | — | A 316X | 25 | 120 | 86 | 5 | 1.05 |
| | 80 | 2316K | + H2316X | 78 | 105 | 17 | — | A2316X | 25 | 120 | 87 | 5 | 1.3 |
| | 80 | 22316E AKE4 | + H2316X | 78 | 105 | 17 | — | A2316X | 25 | 120 | 87 | 5 | 1.3 |
| 75 | 85 | 1217K | + H 217X | 50 | 110 | 18 | — | A 217X | 27 | 128 | 90 | 6 | 1.0 |
| | 85 | 2217K | + H 317X | 63 | 110 | 18 | — | A 317X | 27 | 128 | 91 | 12 | 1.2 |
| | 85 | 22217E AKE4 | + H 317X | 63 | 110 | 18 | — | A 317X | 27 | 128 | 91 | 12 | 1.2 |
| | 85 | 1317K | + H 317X | 63 | 110 | 18 | — | A 317X | 27 | 128 | 91 | 6 | 1.2 |
| | 85 | 21317E AKE4 | + H 317X | 63 | 110 | 18 | — | A 317X | 27 | 128 | 91 | 6 | 1.2 |
| | 85 | 2317K | + H2317X | 82 | 110 | 18 | — | A2317X | 27 | 128 | 94 | 6 | 1.45 |
| | 85 | 22317E AKE4 | + H2317X | 82 | 110 | 18 | — | A2317X | 27 | 128 | 94 | 6 | 1.45 |
| 80 | 90 | 1218K | + H 218X | 52 | 120 | 18 | — | A 218X | 28 | 139 | 95 | 6 | 1.15 |
| | 90 | 2218K | + H 318X | 65 | 120 | 18 | — | A 318X | 28 | 139 | 96 | 10 | 1.4 |
| | 90 | 22218E AKE4 | + H 318X | 65 | 120 | 18 | — | A 318X | 28 | 139 | 96 | 10 | 1.4 |
| | 90 | 1318K | + H 318X | 65 | 120 | 18 | — | A 318X | 28 | 139 | 96 | 6 | 1.4 |
| | 90 | 21318E AKE4 | + H 318X | 65 | 120 | 18 | — | A 318X | 28 | 139 | 96 | 6 | 1.4 |
| | 90 | 2318K | + H2318X | 86 | 120 | 18 | — | A2318X | 28 | 139 | 99 | 6 | 1.7 |
| | 90 | 22318E AKE4 | + H2318X | 86 | 120 | 18 | — | A2318X | 28 | 139 | 99 | 6 | 1.7 |

Notlar X soneki, dar yarıkli adaptör manşonlarını temsil eder, bunlar için düz tırnaklı pullar kullanılmalıdır.

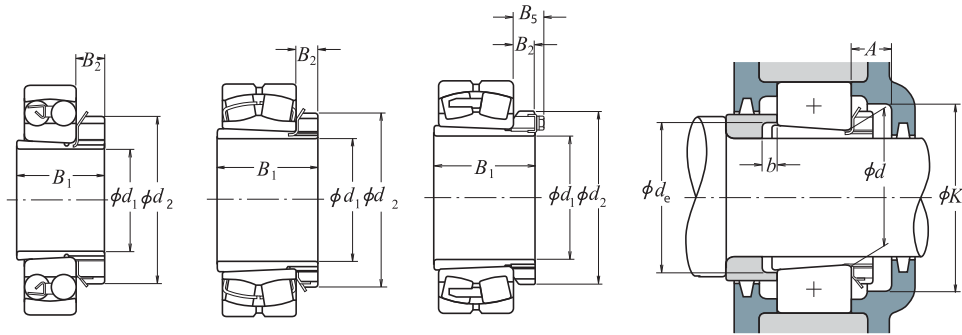

| Mil Çapı (mm) | Nominal Rulman Delik Çapı (mm) | Nominal Numaralar | | Ölçüler (mm) | | | | Adaptör Manşonu Numaraları | Dayanak Ölçüleri (mm) | | | | Kütle (kg) | |
|------------------|---|-------------------|-------------|-----------------|----------------|----------------|----------------|----------------------------------|--------------------------|-----------|------------------------|-----------|---------------|----------|
| | | | | B ₁ | d ₂ | B ₂ | B ₅ | | A min. | K min. | d _e min. | b min. | | yaklaşık |
| 85 | 95 | 1219K | + H 219X | 55 | 125 | 19 | — | A 219X | 29 | 145 | 101 | 7 | 1.35 | |
| | 95 | 2219K | + H 319X | 68 | 125 | 19 | — | A 319X | 29 | 145 | 102 | 9 | 1.55 | |
| | 95 | 22219E AKE4 | + H 319X | 68 | 125 | 19 | — | A 319X | 29 | 145 | 102 | 9 | 1.55 | |
| | 95 | 1319K | + H 319X | 68 | 125 | 19 | — | A 319X | 29 | 145 | 102 | 7 | 1.55 | |
| | 95 | 21319C KE4 | + H 319X | 68 | 125 | 19 | — | A 319X | 29 | 145 | 102 | 7 | 1.55 | |
| | 95 | 2319K | + H2319X | 90 | 125 | 19 | — | A2319X | 29 | 145 | 105 | 7 | 1.9 | |
| | 95 | 22319E AKE4 | + H2319X | 90 | 125 | 19 | — | A2319X | 29 | 145 | 105 | 7 | 1.9 | |
| | 90 | 100 | 1220K | + H 220X | 58 | 130 | 20 | — | A 220X | 30 | 150 | 106 | 7 | 1.45 |
| | | 100 | 2220K | + H 320X | 71 | 130 | 20 | — | A 320X | 30 | 150 | 107 | 8 | 1.7 |
| 100 | | 22220E AKE4 | + H 320X | 71 | 130 | 20 | — | A 320X | 30 | 150 | 107 | 8 | 1.7 | |
| 100 | | 1320K | + H 320X | 71 | 130 | 20 | — | A 320X | 30 | 150 | 107 | 7 | 1.7 | |
| 100 | | 21320C KE4 | + H 320X | 71 | 130 | 20 | — | A 320X | 30 | 150 | 107 | 7 | 1.7 | |
| 100 | | 2320K | + H2320X | 97 | 130 | 20 | — | A2320X | 30 | 150 | 110 | 7 | 2.15 | |
| 100 | | 23220C KE4 | + H2320X | 97 | 130 | 20 | — | A2320X | 30 | 150 | 110 | 7 | 2.15 | |
| 100 | | 22320E AKE4 | + H2320X | 97 | 130 | 20 | — | A2320X | 30 | 150 | 110 | 7 | 2.15 | |
| 100 | | 110 | 23122C KE4 | + H3122X | 81 | 145 | 21 | — | A3122X | 32 | 170 | 117 | 7 | 2.25 |
| | 110 | 1222K | + H 222X | 63 | 145 | 21 | — | A 222X | 32 | 170 | 116 | 7 | 1.95 | |
| | 110 | 2222K | + H 322X | 77 | 145 | 21 | — | A 322X | 32 | 170 | 117 | 6 | 2.3 | |
| | 110 | 22222E AKE4 | + H 322X | 77 | 145 | 21 | — | A 322X | 32 | 170 | 117 | 6 | 2.3 | |
| | 110 | 1322K | + H 322X | 77 | 145 | 21 | — | A 322X | 32 | 170 | 117 | 9 | 2.3 | |
| | 110 | 2322K | + H2322X | 105 | 145 | 21 | — | A2322X | 32 | 170 | 121 | 7 | 2.75 | |
| | 110 | 23222C KE4 | + H2322X | 105 | 145 | 21 | — | A2322X | 32 | 170 | 121 | 17 | 2.75 | |
| | 110 | 22322E AKE4 | + H2322X | 105 | 145 | 21 | — | A2322X | 32 | 170 | 121 | 7 | 2.75 | |
| | 110 | 120 | 23024C DKE4 | + H3024 | 72 | 145 | 22 | — | A 3024 | 33 | 180 | 127 | 7 | 1.95 |
| 120 | | 23124C KE4 | + H3124 | 88 | 155 | 22 | — | A 3124 | 33 | 180 | 128 | 7 | 2.65 | |
| 120 | | 22224E AKE4 | + H3124 | 88 | 155 | 22 | — | A 3124 | 33 | 180 | 128 | 11 | 2.65 | |
| 120 | | 23224C KE4 | + H2324 | 112 | 155 | 22 | — | A 2324 | 33 | 180 | 131 | 17 | 3.2 | |
| 120 | | 22324E AKE4 | + H2324 | 112 | 155 | 22 | — | A 2324 | 33 | 180 | 131 | 7 | 3.2 | |
| 115 | | 130 | 23026C DKE4 | + H3026 | 80 | 155 | 23 | — | A 3026 | 34 | 190 | 137 | 8 | 2.85 |
| | 130 | 23126C KE4 | + H3126 | 92 | 165 | 23 | — | A 3126 | 34 | 190 | 138 | 8 | 3.65 | |
| | 130 | 22226E AKE4 | + H3126 | 92 | 165 | 23 | — | A 3126 | 34 | 190 | 138 | 8 | 3.65 | |
| | 130 | 23226C KE4 | + H2326 | 121 | 165 | 23 | — | A 2326 | 34 | 190 | 142 | 21 | 4.6 | |
| | 130 | 22326C KE4 | + H2326 | 121 | 165 | 23 | — | A 2326 | 34 | 190 | 142 | 8 | 4.6 | |

Notlar X soneki, dar yarıkli adaptör manşonlarını temsil eder, bunlar için düz tırnaklı pullar kullanılmalıdır.

RULMANLARIN ADAPTÖRLERİ

Mil Çapı 125 – 170 mm

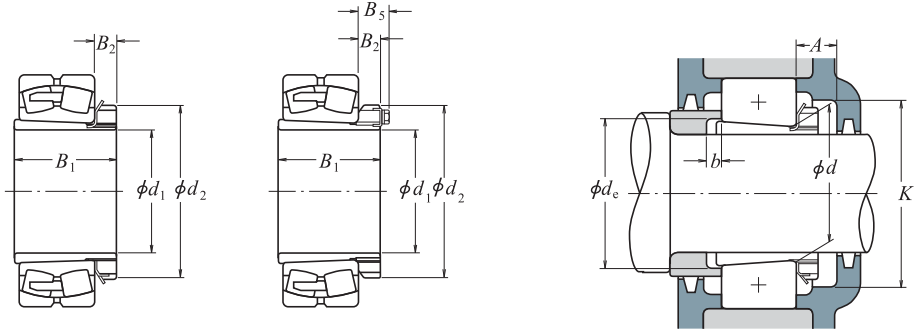

| Mil Çapı (mm) | Nominal Rulman Delik Çapı (mm) | Nominal Numaralar | Ölçüler (mm) | | | | Adaptör Manşonu Numaraları | Dayanak Ölçüleri (mm) | | | | Kütle (kg) |
|------------------|---|-----------------------------|-----------------|-------|-------|-------|----------------------------------|--------------------------|-------------|---------------|-------------|---------------|
| | | | B_1 | d_2 | B_2 | B_5 | | A min. | K min. | d_e min. | b min. | |
| 125 | 140 | 23028C DKE4 + H3028 | 82 | 165 | 24 | — | A 3028 | 36 | 205 | 147 | 8 | 3.15 |
| | 140 | 23128C KE4 + H3128 | 97 | 180 | 24 | — | A 3128 | 36 | 205 | 149 | 8 | 4.35 |
| | 140 | 22228C DKE4 + H3128 | 97 | 180 | 24 | — | A 3128 | 36 | 205 | 149 | 8 | 4.35 |
| 140 | 140 | 23228C KE4 + H2328 | 131 | 180 | 24 | — | A 2328 | 36 | 205 | 152 | 22 | 5.55 |
| | 140 | 22328C KE4 + H2328 | 131 | 180 | 24 | — | A 2328 | 36 | 205 | 152 | 8 | 5.55 |
| 135 | 150 | 23030C DKE4 + H3030 | 87 | 180 | 26 | — | A 3030 | 37 | 220 | 158 | 8 | 3.9 |
| | 150 | 23130C KE4 + H3130 | 111 | 195 | 26 | — | A 3130 | 37 | 220 | 160 | 8 | 5.5 |
| | 150 | 22230C DKE4 + H3130 | 111 | 195 | 26 | — | A 3130 | 37 | 220 | 160 | 15 | 5.5 |
| | 150 | 23230C KE4 + H2330 | 139 | 195 | 26 | — | A 2330 | 37 | 220 | 163 | 20 | 6.6 |
| 150 | 150 | 22330C AKE4 + H2330 | 139 | 195 | 26 | — | A 2330 | 37 | 220 | 163 | 8 | 6.6 |
| | 160 | 23932C AKE4 + H3932 | 78 | 190 | 28 | — | A 3932 | 39 | 205 | 168 | 8 | 4.64 |
| 140 | 160 | 23032C DKE4 + H3032 | 93 | 190 | 28 | — | A 3032 | 39 | 230 | 168 | 8 | 5.2 |
| | 160 | 23132C KE4 + H3132 | 119 | 210 | 28 | — | A 3132 | 39 | 230 | 170 | 8 | 7.65 |
| | 160 | 22232C DKE4 + H3132 | 119 | 210 | 28 | — | A 3132 | 39 | 230 | 170 | 14 | 7.65 |
| 160 | 160 | 23232C KE4 + H2332 | 147 | 210 | 28 | — | A 2332 | 39 | 230 | 174 | 18 | 9.15 |
| | 160 | 22332C AKE4 + H2332 | 147 | 210 | 28 | — | A 2332 | 39 | 230 | 174 | 8 | 9.15 |
| | 170 | 23934B CAKE4 + H3934 | 79 | 200 | 29 | — | A 3934 | 40 | 215 | 179 | 8 | 5.07 |
| 150 | 170 | 23034C DKE4 + H3034 | 101 | 200 | 29 | — | A 3034 | 40 | 250 | 179 | 8 | 6.0 |
| | 170 | 23134C KE4 + H3134 | 122 | 220 | 29 | — | A 3134 | 40 | 250 | 180 | 8 | 8.4 |
| | 170 | 22234C DKE4 + H3134 | 122 | 220 | 29 | — | A 3134 | 40 | 250 | 180 | 10 | 8.4 |
| 170 | 170 | 23234C KE4 + H2334 | 154 | 220 | 29 | — | A 2334 | 40 | 250 | 185 | 18 | 10 |
| | 170 | 22334C AKE4 + H2334 | 154 | 220 | 29 | — | A 2334 | 40 | 250 | 185 | 8 | 10 |
| | 180 | 23936C AKE4 + H3936 | 87 | 210 | 30 | — | A 3936 | 41 | 230 | 189 | 8 | 5.87 |
| 160 | 180 | 23036C DKE4 + H3036 | 109 | 210 | 30 | — | A 3036 | 41 | 260 | 189 | 8 | 6.85 |
| | 180 | 23136C KE4 + H3136 | 131 | 230 | 30 | — | A 3136 | 41 | 260 | 191 | 8 | 9.5 |
| | 180 | 22236C DKE4 + H3136 | 131 | 230 | 30 | — | A 3136 | 41 | 260 | 191 | 18 | 9.5 |
| 180 | 180 | 23236C KE4 + H2336 | 161 | 230 | 30 | — | A 2336 | 41 | 260 | 195 | 22 | 11.5 |
| | 180 | 22336C AKE4 + H2336 | 161 | 230 | 30 | — | A 2336 | 41 | 260 | 195 | 8 | 11.5 |
| | 190 | 23938C AKE4 + H3938 | 89 | 220 | 31 | — | A 3938 | 43 | 240 | 199 | 9 | 6.35 |
| 170 | 190 | 23038C AKE4 + H3038 | 112 | 220 | 31 | — | A 3038 | 43 | 270 | 199 | 9 | 7.45 |
| | 190 | 23138C KE4 + H3138 | 141 | 240 | 31 | — | A 3138 | 43 | 270 | 202 | 9 | 11 |
| | 190 | 22238C AKE4 + H3138 | 141 | 240 | 31 | — | A 3138 | 43 | 270 | 202 | 21 | 11 |
| 190 | 190 | 23238C KE4 + H2338 | 169 | 240 | 31 | — | A 2338 | 43 | 270 | 206 | 21 | 12.5 |
| | 190 | 22338C AKE4 + H2338 | 169 | 240 | 31 | — | A 2338 | 43 | 270 | 206 | 9 | 12.5 |

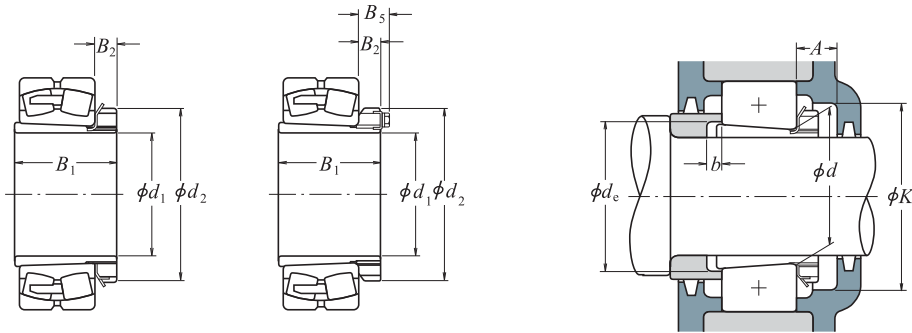

| Mil Çapı (mm) | Nominal Rulman Delik Çapı (mm) | Nominal Numaralar | Ölçüler (mm) | | | | Adaptör Manşonu Numaraları | Dayanak Ölçüleri (mm) | | | | Kütle (kg) | |
|------------------|---|-----------------------------|-----------------------------|-------|-------|-------|----------------------------------|--------------------------|-------------|---------------|-------------|---------------|----------|
| | | | B_1 | d_2 | B_2 | B_5 | | A min. | K min. | d_c min. | b min. | | yaklaşık |
| 180 | 200 | 23940C AKE4 + H 3940 | 98 | 240 | 32 | — | A 3940 | 46 | 260 | 210 | 10 | 8.0 | |
| | 200 | 23040C AKE4 + H 3040 | 120 | 240 | 32 | — | A 3040 | 46 | 280 | 210 | 10 | 9.2 | |
| | 200 | 23140C KE4 + H 3140 | 150 | 250 | 32 | — | A 3140 | 46 | 280 | 212 | 10 | 12 | |
| | 200 | 22240C AKE4 + H 3140 | 150 | 250 | 32 | — | A 3140 | 46 | 280 | 212 | 24 | 12 | |
| | 200 | 23240C KE4 + H 2340 | 176 | 250 | 32 | — | A 2340 | 46 | 280 | 216 | 20 | 14 | |
| | 200 | 22340C AKE4 + H 2340 | 176 | 250 | 32 | — | A 2340 | 46 | 280 | 216 | 10 | 14 | |
| | 200 | 220 | 23944C AKE4 + H 3944 | 96 | 260 | 30 | 41 | A 3944 | 55 | 280 | 231 | 10 | 8.32 |
| | | 220 | 23044C AKE4 + H 3044 | 128 | 260 | 30 | 41 | A 3044 | 55 | 320 | 231 | 12 | 10.5 |
| | | 220 | 23144C KE4 + H 3144 | 158 | 280 | 32 | 44 | A 3144 | 55 | 320 | 233 | 10 | 14.5 |
| 220 | | 22244C AKE4 + H 3144 | 158 | 280 | 32 | 44 | A 3144 | 55 | 320 | 233 | 22 | 14.5 | |
| 220 | | 23244C KE4 + H 2344 | 183 | 280 | 32 | 44 | A 2344 | 55 | 320 | 236 | 11 | 16.5 | |
| 220 | | 22344C AKE4 + H 2344 | 183 | 280 | 32 | 44 | A 2344 | 55 | 320 | 236 | 10 | 16.5 | |
| 220 | | 240 | 23948C AKE4 + H 3948 | 101 | 290 | 34 | 46 | A 3948 | 60 | 300 | 251 | 11 | 11.2 |
| | | 240 | 23048C AKE4 + H 3048 | 133 | 290 | 34 | 46 | A 3048 | 60 | 340 | 251 | 11 | 13 |
| | | 240 | 23148C KE4 + H 3148 | 169 | 300 | 34 | 46 | A 3148 | 60 | 340 | 254 | 11 | 17.5 |
| | 240 | 22248C AKE4 + H 3148 | 169 | 300 | 34 | 46 | A 3148 | 60 | 340 | 254 | 19 | 17.5 | |
| | 240 | 23248C AKE4 + H 2348 | 196 | 300 | 34 | 46 | A 2348 | 60 | 340 | 257 | 6 | 19.5 | |
| | 240 | 22348C AKE4 + H 2348 | 196 | 300 | 34 | 46 | A 2348 | 60 | 340 | 257 | 11 | 19.5 | |
| | 240 | 260 | 23952C AKE4 + H 3952 | 116 | 310 | 34 | 46 | A 3952 | 60 | 330 | 272 | 11 | 13.4 |
| | | 260 | 23052C AKE4 + H 3052 | 147 | 310 | 34 | 46 | A 3052 | 60 | 370 | 272 | 13 | 15.5 |
| | | 260 | 23152C AKE4 + H 3152 | 187 | 330 | 36 | 49 | A 3152 | 60 | 370 | 276 | 11 | 22 |
| 260 | | 22252C AKE4 + H 3152 | 187 | 330 | 36 | 49 | A 3152 | 60 | 370 | 276 | 25 | 22 | |
| 260 | | 23252C AKE4 + H 2352 | 208 | 330 | 36 | 49 | A 2352 | 60 | 370 | 278 | 2 | 24 | |
| 260 | | 22352C AKE4 + H 2352 | 208 | 330 | 36 | 49 | A 2352 | 60 | 370 | 278 | 11 | 24 | |
| 260 | 280 | 23956C AKE4 + H 3956 | 121 | 330 | 38 | 50 | A 3956 | 65 | 350 | 292 | 12 | 15.5 | |
| | 280 | 23056C AKE4 + H 3056 | 152 | 330 | 38 | 50 | A 3056 | 65 | 390 | 292 | 12 | 17.5 | |
| | 280 | 23156C AKE4 + H 3156 | 192 | 350 | 38 | 51 | A 3156 | 65 | 390 | 296 | 12 | 24.5 | |
| | 280 | 22256C AKE4 + H 3156 | 192 | 350 | 38 | 51 | A 3156 | 65 | 390 | 296 | 28 | 24.5 | |
| | 280 | 23256C AKE4 + H 2356 | 221 | 350 | 38 | 51 | A 2356 | 65 | 390 | 299 | 11 | 28 | |
| | 280 | 22356C AKE4 + H 2356 | 221 | 350 | 38 | 51 | A 2356 | 65 | 390 | 299 | 12 | 28 | |

RULMANLARIN ADAPTÖRLERİ

Mil Çapı 280 – 410 mm

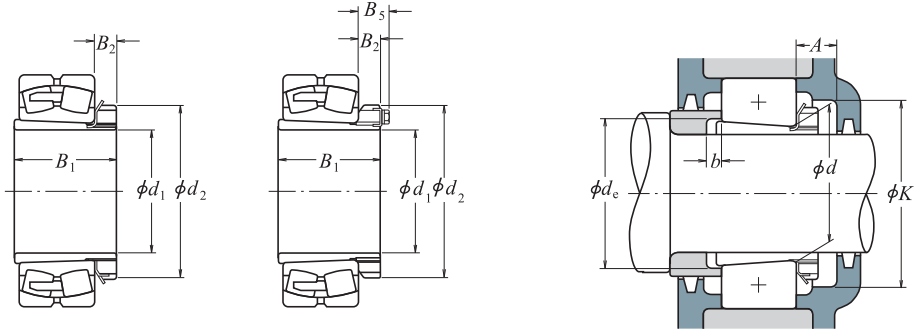

| Mil Çapı (mm) | Nominal Rulman Delik Çapı (mm) | Nominal Numaralar | Ölçüler (mm) | | | | Adaptör Manşonu Numaraları | Dayanak Ölçüleri (mm) | | | | Kütle (kg) |
|------------------|---|----------------------------|-----------------|-------|-------|-------|----------------------------------|--------------------------|-------------|---------------|-------------|---------------|
| | | | B_1 | d_2 | B_2 | B_5 | | A min. | K min. | d_c min. | b min. | |
| 280 | 300 | 23960C AKE4 + H3960 | 140 | 360 | 42 | 54 | A3960 | 69 | 380 | 313 | 12 | 20.7 |
| | 300 | 23060C AKE4 + H3060 | 168 | 360 | 42 | 54 | A3060 | 69 | 430 | 313 | 12 | 23 |
| | 300 | 23160C AKE4 + H3160 | 208 | 380 | 40 | 53 | A3160 | 69 | 430 | 317 | 12 | 30 |
| 300 | 300 | 22260C AKE4 + H3160 | 208 | 380 | 40 | 53 | A3160 | 69 | 430 | 317 | 32 | 30 |
| | 300 | 23260C AKE4 + H3260 | 240 | 380 | 40 | 53 | A3260 | 69 | 430 | 321 | 12 | 34 |
| 300 | 320 | 23964C AKE4 + H3964 | 140 | 380 | 42 | 55 | A3964 | 72 | 400 | 334 | 13 | 21.8 |
| | 320 | 23064C AKE4 + H3064 | 171 | 380 | 42 | 55 | A3064 | 72 | 450 | 334 | 13 | 24.5 |
| | 320 | 23164C AKE4 + H3164 | 226 | 400 | 42 | 56 | A3164 | 72 | 450 | 339 | 13 | 35 |
| 320 | 320 | 22264C AKE4 + H3164 | 226 | 400 | 42 | 56 | A3164 | 72 | 450 | 339 | 39 | 35 |
| | 320 | 23264C AKE4 + H3264 | 258 | 400 | 42 | 56 | A3264 | 72 | 450 | 343 | 13 | 39.5 |
| 320 | 340 | 23968C AKE4 + H3968 | 144 | 400 | 45 | 58 | A3968 | 75 | 430 | 354 | 14 | 24.6 |
| | 340 | 23068C AKE4 + H3068 | 187 | 400 | 45 | 58 | A3068 | 75 | 490 | 355 | 14 | 28.5 |
| | 340 | 23168C AKE4 + H3168 | 254 | 440 | 55 | 72 | A3168 | 75 | 490 | 360 | 14 | 49.5 |
| | 340 | 23268C AKE4 + H3268 | 288 | 440 | 55 | 72 | A3268 | 75 | 490 | 364 | 14 | 54.5 |
| 340 | 360 | 23972C AKE4 + H3972 | 144 | 420 | 45 | 58 | A3972 | 75 | 450 | 374 | 14 | 25.7 |
| | 360 | 23072C AKE4 + H3072 | 188 | 420 | 45 | 58 | A3072 | 75 | 510 | 375 | 14 | 30.5 |
| | 360 | 23172C AKE4 + H3172 | 259 | 460 | 58 | 75 | A3172 | 75 | 510 | 380 | 14 | 54 |
| | 360 | 23272C AKE4 + H3272 | 299 | 460 | 58 | 75 | A3272 | 75 | 510 | 385 | 14 | 60.5 |
| 360 | 380 | 23976C AKE4 + H3976 | 164 | 450 | 48 | 62 | A3976 | 82 | 480 | 396 | 15 | 31.9 |
| | 380 | 23076C AKE4 + H3076 | 193 | 450 | 48 | 62 | A3076 | 82 | 540 | 396 | 15 | 36 |
| | 380 | 23176C AKE4 + H3176 | 264 | 490 | 60 | 77 | A3176 | 82 | 540 | 401 | 15 | 61.5 |
| | 380 | 23276C AKE4 + H3276 | 310 | 490 | 60 | 77 | A3276 | 82 | 540 | 405 | 15 | 69.5 |
| 380 | 400 | 23980C AKE4 + H3980 | 168 | 470 | 52 | 66 | A3980 | 86 | 500 | 417 | 15 | 35.2 |
| | 400 | 23080C AKE4 + H3080 | 210 | 470 | 52 | 66 | A3080 | 86 | 580 | 417 | 15 | 41.5 |
| | 400 | 23180C AKE4 + H3180 | 272 | 520 | 62 | 82 | A3180 | 86 | 580 | 421 | 15 | 70.5 |
| | 400 | 23280C AKE4 + H3280 | 328 | 520 | 62 | 82 | A3280 | 86 | 580 | 427 | 15 | 81 |
| 400 | 420 | 23984C AKE4 + H3984 | 168 | 490 | 52 | 66 | A3984 | 86 | 520 | 437 | 16 | 36.6 |
| | 420 | 23084C AKE4 + H3084 | 212 | 490 | 52 | 66 | A3084 | 86 | 600 | 437 | 16 | 43.5 |
| | 420 | 23184C AKE4 + H3184 | 304 | 540 | 70 | 90 | A3184 | 86 | 600 | 443 | 16 | 84 |
| | 420 | 23284C AKE4 + H3284 | 352 | 540 | 70 | 90 | A3284 | 86 | 600 | 448 | 16 | 94 |
| 410 | 440 | 23988C AKE4 + H3988 | 189 | 520 | 60 | 77 | A3988 | 99 | 550 | 458 | 17 | 58.6 |
| | 440 | 23088C AKE4 + H3088 | 228 | 520 | 60 | 77 | A3088 | 99 | 620 | 458 | 17 | 65 |
| | 440 | 23188C AKE4 + H3188 | 307 | 560 | 70 | 90 | A3188 | 99 | 620 | 464 | 17 | 104 |
| | 440 | 23288C AKE4 + H3288 | 361 | 560 | 70 | 90 | A3288 | 99 | 620 | 469 | 17 | 118 |

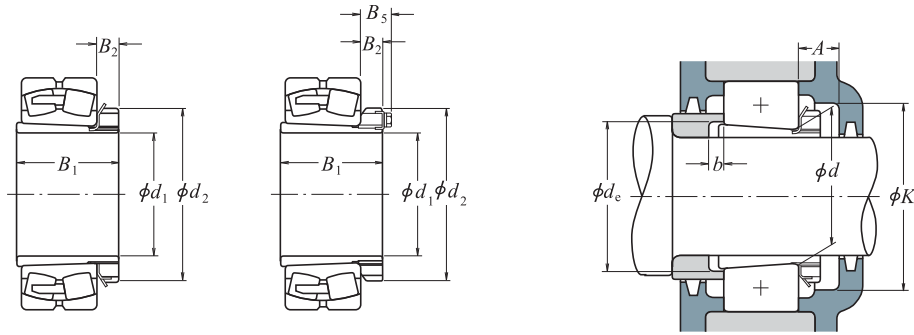

| Mil Çapı (mm) | Nominal Rulman Delik Çapı (mm) | Nominal Numaralar | Ölçüler (mm) | | | | Adaptör Manşonu Numaraları | Dayanak Ölçüleri (mm) | | | | Kütle (kg) |
|------------------|---|---------------------------------|-----------------|-------|-------|-------|----------------------------------|--------------------------|-------------|---------------|-------------|---------------|
| | | | B_1 | d_2 | B_2 | B_5 | | A min. | K min. | d_c min. | b min. | |
| 430 | 460 | 23992C AKE4 + H 3992 | 189 | 540 | 60 | 77 | A 3992 | 99 | 570 | 478 | 17 | 62 |
| | 460 | 23092C AKE4 + H 3092 | 234 | 540 | 60 | 77 | A 3092 | 99 | 650 | 478 | 17 | 69.5 |
| | 460 | 23192C AKE4 + H 3192 | 326 | 580 | 75 | 95 | A 3192 | 99 | 650 | 485 | 17 | 116 |
| | 460 | 23292C AKE4 + H 3292 | 382 | 580 | 75 | 95 | A 3292 | 99 | 650 | 491 | 17 | 132 |
| 450 | 480 | 23996C AKE4 + H 3996 | 200 | 560 | 60 | 77 | A 3996 | 99 | 600 | 499 | 18 | 67.5 |
| | 480 | 23096C AKE4 + H 3096 | 237 | 560 | 60 | 77 | A 3096 | 99 | 690 | 499 | 18 | 73.5 |
| | 480 | 23196C AKE4 + H 3196 | 335 | 620 | 75 | 95 | A 3196 | 99 | 690 | 505 | 18 | 133 |
| | 480 | 23296C AKE4 + H 3296 | 397 | 620 | 75 | 95 | A 3296 | 99 | 690 | 512 | 18 | 152 |
| 470 | 500 | 239/500C AKE4 + H 39/500 | 208 | 580 | 68 | 85 | A 39/500 | 109 | 620 | 519 | 18 | 74.6 |
| | 500 | 230/500C AKE4 + H 30/500 | 247 | 580 | 68 | 85 | A 30/500 | 109 | 700 | 519 | 18 | 82 |
| | 500 | 231/500C AKE4 + H 31/500 | 356 | 630 | 80 | 100 | A 31/500 | 109 | 700 | 527 | 18 | 143 |
| | 500 | 232/500C AKE4 + H 32/500 | 428 | 630 | 80 | 100 | A 32/500 | 109 | 700 | 534 | 18 | 166 |

RULMANLARIN ÇEKME MANŞONLARI

Mil Çapı 35 – 85 mm

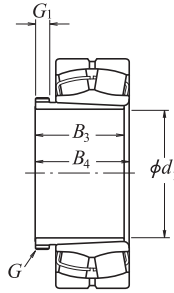

| Mil Çapı (mm) d_1 | Nominal Rulman Delik Çapı (mm) d | Nominal Numaralar | Vida Dişi G | Ölçüler (mm) | | | Kütle (kg) yaklaşık |
|---------------------------|--|------------------------------|------------------|------------------|-------|-------|---------------------------|
| | | | | Mevcut Rulmanlar | B_3 | G_1 | |
| 35 | 40 | 21308EAKE4 + AH 308 | M 45 X 1.5 | 29 | 6 | 32 | 0.09 |
| | 40 | 22308EAKE4 + AH 2308 | M 45 X 1.5 | 40 | 7 | 43 | 0.13 |
| 40 | 45 | 21309EAKE4 + AH 309 | M 50 X 1.5 | 31 | 6 | 34 | 0.11 |
| | 45 | 22309EAKE4 + AH 2309 | M 50 X 1.5 | 44 | 7 | 47 | 0.165 |
| 45 | 50 | 21310EAKE4 + AHX 310 | M 55 X 2 | 35 | 7 | 38 | 0.16 |
| | 50 | 22310EAKE4 + AHX 2310 | M 55 X 2 | 50 | 9 | 53 | 0.235 |
| 50 | 55 | 22211EAKE4 + AHX 311 | M 60 X 2 | 37 | 7 | 40 | 0.19 |
| | 55 | 21311EAKE4 + AHX 311 | M 60 X 2 | 37 | 7 | 40 | 0.19 |
| | 55 | 22311EAKE4 + AHX 2311 | M 60 X 2 | 54 | 10 | 57 | 0.285 |
| 55 | 60 | 22212EAKE4 + AHX 312 | M 65 X 2 | 40 | 8 | 43 | 0.215 |
| | 60 | 21312EAKE4 + AHX 312 | M 65 X 2 | 40 | 8 | 43 | 0.215 |
| | 60 | 22312EAKE4 + AHX 2312 | M 65 X 2 | 58 | 11 | 61 | 0.34 |
| 60 | 65 | 22213EAKE4 + AH 313 | M 75 X 2 | 42 | 8 | 45 | 0.255 |
| | 65 | 21313EAKE4 + AH 313 | M 75 X 2 | 42 | 8 | 45 | 0.255 |
| | 65 | 22313EAKE4 + AH 2313 | M 75 X 2 | 61 | 12 | 64 | 0.395 |
| 65 | 70 | 22214EAKE4 + AH 314 | M 80 X 2 | 43 | 8 | 47 | 0.28 |
| | 70 | 21314EAKE4 + AH 314 | M 80 X 2 | 43 | 8 | 47 | 0.28 |
| | 70 | 22314EAKE4 + AHX 2314 | M 80 X 2 | 64 | 12 | 68 | 0.53 |
| 70 | 75 | 22215EAKE4 + AH 315 | M 85 X 2 | 45 | 8 | 49 | 0.315 |
| | 75 | 21315EAKE4 + AH 315 | M 85 X 2 | 45 | 8 | 49 | 0.315 |
| | 75 | 22315EAKE4 + AHX 2315 | M 85 X 2 | 68 | 12 | 72 | 0.605 |
| 75 | 80 | 22216EAKE4 + AH 316 | M 90 X 2 | 48 | 8 | 52 | 0.365 |
| | 80 | 21316EAKE4 + AH 316 | M 90 X 2 | 48 | 8 | 52 | 0.365 |
| | 80 | 22316EAKE4 + AHX 2316 | M 90 X 2 | 71 | 12 | 75 | 0.665 |
| 80 | 85 | 22217EAKE4 + AHX 317 | M 95 X 2 | 52 | 9 | 56 | 0.48 |
| | 85 | 21317EAKE4 + AHX 317 | M 95 X 2 | 52 | 9 | 56 | 0.48 |
| | 85 | 22317EAKE4 + AHX 2317 | M 95 X 2 | 74 | 13 | 78 | 0.745 |
| 85 | 90 | 22218EAKE4 + AHX 318 | M 100 X 2 | 53 | 9 | 57 | 0.52 |
| | 90 | 21318EAKE4 + AHX 318 | M 100 X 2 | 53 | 9 | 57 | 0.52 |
| | 90 | 23218CKE4 + AH 3218 | M 100 X 2 | 63 | 10 | 67 | 0.58 |
| | 90 | 22318EAKE4 + AHX 2318 | M 100 X 2 | 79 | 14 | 83 | 0.845 |

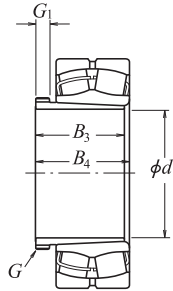

| Mil Çapı (mm) d_1 | Nominal Rulman Delik Çapı (mm) d | Nominal Numaralar | Vida Dişi G | Ölçüler (mm) | | | Kütle (kg) yaklaşık |
|---------------------------|--|-------------------------------|----------------------|-----------------|-------|-------|---------------------------|
| | | | | B_3 | G_1 | B_4 | |
| 90 | 95 | 22219EAKE4 + AHX 319 | M 105 X 2 | 57 | 10 | 61 | 0.595 |
| | 95 | 21319CKE4 + AHX 319 | M 105 X 2 | 57 | 10 | 61 | 0.595 |
| | 95 | 22319EAKE4 + AHX 2319 | M 105 X 2 | 85 | 16 | 89 | 0.89 |
| 95 | 100 | 21320CKE4 + AHX 3120 | M 110 X 2 | 64 | 11 | 68 | 0.70 |
| | 100 | 22220EAKE4 + AHX 320 | M 110 X 2 | 59 | 10 | 63 | 0.66 |
| | 100 | 21320CKE4 + AHX 320 | M 110 X 2 | 59 | 10 | 63 | 0.66 |
| | 100 | 23220CKE4 + AHX 3220 | M 110 X 2 | 73 | 11 | 77 | 0.77 |
| | 100 | 22320EAKE4 + AHX 2320 | M 110 X 2 | 90 | 16 | 94 | 1.0 |
| 105 | 110 | 23122CKE4 + AHX 3122 | M 120 X 2 | 68 | 11 | 72 | 0.76 |
| | 110 | 22222EAKE4 + AHX 3122 | M 120 X 2 | 68 | 11 | 72 | 0.76 |
| | 110 | 24122CK30E4 + AH 24122 | M 115 X 2 | 82 | 13 | 91 | 0.73 |
| 115 | 110 | 23222CKE4 + AHX 3222 | M 125 X 2 | 82 | 11 | 86 | 1.04 |
| | 110 | 22322EAKE4 + AHX 2322 | M 125 X 2 | 98 | 16 | 102 | 1.35 |
| | 120 | 23024CDKE4 + AHX 3024 | M 130 X 2 | 60 | 13 | 64 | 0.75 |
| 125 | 120 | 24024CK30E4 + AH 24024 | M 125 X 2 | 73 | 13 | 82 | 0.70 |
| | 120 | 23124CKE4 + AHX 3124 | M 130 X 2 | 75 | 12 | 79 | 0.95 |
| | 120 | 22224EAKE4 + AHX 3124 | M 130 X 2 | 75 | 12 | 79 | 0.95 |
| | 120 | 24124CK30E4 + AH 24124 | M 130 X 2 | 93 | 13 | 102 | 1.02 |
| | 120 | 23224CKE4 + AHX 3224 | M 135 X 2 | 90 | 13 | 94 | 1.3 |
| | 120 | 22324EAKE4 + AHX 2324 | M 135 X 2 | 105 | 17 | 109 | 1.6 |
| | 130 | 23026CDKE4 + AHX 3026 | M 140 X 2 | 67 | 14 | 71 | 0.95 |
| 135 | 130 | 24026CK30E4 + AH 24026 | M 135 X 2 | 83 | 14 | 93 | 0.89 |
| | 130 | 23126CKE4 + AHX 3126 | M 140 X 2 | 78 | 12 | 82 | 1.08 |
| | 130 | 22226EAKE4 + AHX 3126 | M 140 X 2 | 78 | 12 | 82 | 1.08 |
| | 130 | 24126CK30E4 + AH 24126 | M 140 X 2 | 94 | 14 | 104 | 1.14 |
| | 130 | 23226CKE4 + AHX 3226 | M 145 X 2 | 98 | 15 | 102 | 1.58 |
| | 130 | 22326CKE4 + AHX 2326 | M 145 X 2 | 115 | 19 | 119 | 1.97 |
| | 140 | 23028CDKE4 + AHX 3028 | M 150 X 2 | 68 | 14 | 73 | 1.01 |
| 140 | 140 | 24028CK30E4 + AH 24028 | M 145 X 2 | 83 | 14 | 93 | 0.96 |
| | 140 | 23128CKE4 + AHX 3128 | M 150 X 2 | 83 | 14 | 88 | 1.28 |
| | 140 | 22228CDKE4 + AHX 3128 | M 150 X 2 | 83 | 14 | 88 | 1.28 |
| | 140 | 24128CK30E4 + AH 24128 | M 150 X 2 | 99 | 14 | 109 | 1.3 |
| | 140 | 23228CKE4 + AHX 3228 | M 155 X 3 | 104 | 15 | 109 | 1.84 |
| | 140 | 22328CKE4 + AHX 2328 | M 155 X 3 | 125 | 20 | 130 | 2.33 |

RULMANLARIN ÇEKME MANŞONLARI

Mil Çapı 145 – 180 mm

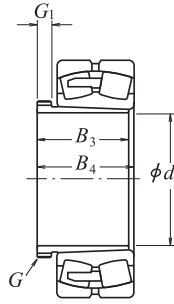

| Mil Çapı (mm) d_1 | Nominal Rulman Delik Çapı (mm) d | Nominal Numaralar | Vida Dişi G | Ölçüler (mm) | | | Kütle (kg) yaklaşık |
|---------------------------|--|------------------------|----------------------|------------------|-------|-------|---------------------------|
| | | | | Mevcut Rulmanlar | B_3 | G_1 | |
| 145 | 150 | 23030CDKE4 + AHX 3030 | M 160 X 3 | 72 | 15 | 77 | 1.15 |
| | 150 | 24030CK30E4 + AH 24030 | M 155 X 3 | 90 | 15 | 101 | 1.11 |
| | 150 | 23130CKE4 + AHX 3130 | M 165 X 3 | 96 | 15 | 101 | 1.79 |
| | 150 | 22230CDKE4 + AHX 3130 | M 165 X 3 | 96 | 15 | 101 | 1.79 |
| | 150 | 24130CK30E4 + AH 24130 | M 160 X 3 | 115 | 15 | 126 | 1.63 |
| | 150 | 23230CKE4 + AHX 3230 | M 165 X 3 | 114 | 17 | 119 | 2.22 |
| 150 | 150 | 22330CAKE4 + AHX 2330 | M 165 X 3 | 135 | 24 | 140 | 2.82 |
| | 160 | 23032CDKE4 + AH 3032 | M 170 X 3 | 77 | 16 | 82 | 2.05 |
| | 160 | 24032CK30E4 + AH 24032 | M 170 X 3 | 95 | 15 | 106 | 2.28 |
| | 160 | 23132CKE4 + AH 3132 | M 180 X 3 | 103 | 16 | 108 | 3.2 |
| | 160 | 22232CDKE4 + AH 3132 | M 180 X 3 | 103 | 16 | 108 | 3.2 |
| | 160 | 24132CK30E4 + AH 24132 | M 170 X 3 | 124 | 15 | 135 | 3.03 |
| 160 | 160 | 23232CKE4 + AH 3232 | M 180 X 3 | 124 | 20 | 130 | 4.1 |
| | 160 | 22332CAKE4 + AH 2332 | M 180 X 3 | 140 | 24 | 146 | 4.7 |
| | 170 | 23034CDKE4 + AH 3034 | M 180 X 3 | 85 | 17 | 90 | 2.45 |
| | 170 | 24034CK30E4 + AH 24034 | M 180 X 3 | 106 | 16 | 117 | 2.74 |
| | 170 | 23134CKE4 + AH 3134 | M 190 X 3 | 104 | 16 | 109 | 3.4 |
| | 170 | 22234CDKE4 + AH 3134 | M 190 X 3 | 104 | 16 | 109 | 3.4 |
| 170 | 170 | 24134CK30E4 + AH 24134 | M 180 X 3 | 125 | 16 | 136 | 3.26 |
| | 170 | 23234CKE4 + AH 3234 | M 190 X 3 | 134 | 24 | 140 | 4.8 |
| | 170 | 22334CAKE4 + AH 2334 | M 190 X 3 | 146 | 24 | 152 | 5.25 |
| | 180 | 23036CDKE4 + AH 3036 | M 190 X 3 | 92 | 17 | 98 | 2.8 |
| | 180 | 24036CK30E4 + AH 24036 | M 190 X 3 | 116 | 16 | 127 | 3.19 |
| | 180 | 23136CKE4 + AH 3136 | M 200 X 3 | 116 | 19 | 122 | 4.2 |
| 180 | 180 | 24136CK30E4 + AH 24136 | M 190 X 3 | 134 | 16 | 145 | 3.74 |
| | 180 | 22236CDKE4 + AH 2236 | M 200 X 3 | 105 | 17 | 110 | 3.75 |
| | 180 | 23236CKE4 + AH 3236 | M 200 X 3 | 140 | 24 | 146 | 5.3 |
| | 180 | 22336CAKE4 + AH 2336 | M 200 X 3 | 154 | 26 | 160 | 5.85 |
| | 190 | 23038CAKE4 + AH 3038 | Tr 205 X 4 | 96 | 18 | 102 | 3.35 |
| | 190 | 24038CK30E4 + AH 24038 | M 200 X 3 | 118 | 18 | 131 | 3.47 |
| 180 | 190 | 23138CKE4 + AH 3138 | Tr 210 X 4 | 125 | 20 | 131 | 4.9 |
| | 190 | 24138CK30E4 + AH 24138 | M 200 X 3 | 146 | 18 | 159 | 4.38 |
| | 190 | 22238CAKE4 + AH 2238 | Tr 210 X 4 | 112 | 18 | 117 | 4.25 |
| | 190 | 23238CKE4 + AH 3238 | Tr 210 X 4 | 145 | 25 | 152 | 5.9 |
| | 190 | 22338CAKE4 + AH 2338 | Tr 210 X 4 | 160 | 26 | 167 | 6.65 |

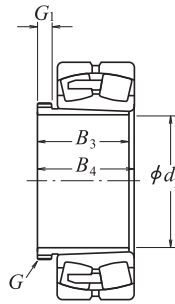

| Mil Çapı (mm) d_1 | Nominal Rulman Delik Çapı (mm) d | Nominal Numaralar | | Vida Dişi | Ölçüler (mm) | | | Kütle (kg) |
|---------------------------|--|-------------------|------------|------------|-----------------|-------|-------|---------------|
| | | | | G | B_3 | G_1 | B_4 | yaklaşık |
| 190 | 200 | 23040CAKE4 | + AH 3040 | Tr 215 × 4 | 102 | 19 | 108 | 3.8 |
| | 200 | 24040CK30E4 | + AH 24040 | Tr 210 × 4 | 127 | 18 | 140 | 3.92 |
| | 200 | 23140CKE4 | + AH 3140 | Tr 220 × 4 | 134 | 21 | 140 | 5.5 |
| | 200 | 24140CK30E4 | + AH 24140 | Tr 210 × 4 | 158 | 18 | 171 | 5.0 |
| | 200 | 22240CAKE4 | + AH 2240 | Tr 220 × 4 | 118 | 19 | 123 | 4.7 |
| | 200 | 23240CKE4 | + AH 3240 | Tr 220 × 4 | 153 | 25 | 160 | 6.7 |
| | 200 | 22340CAKE4 | + AH 2340 | Tr 220 × 4 | 170 | 30 | 177 | 7.55 |
| | 200 | 220 | 23044CAKE4 | + AH 3044 | Tr 235 × 4 | 111 | 20 | 117 |
| 220 | | 24044CK30E4 | + AH 24044 | Tr 230 × 4 | 138 | 20 | 152 | 8.23 |
| 220 | | 23144CKE4 | + AH 3144 | Tr 240 × 4 | 145 | 23 | 151 | 10.5 |
| 220 | | 24144CK30E4 | + AH 24144 | Tr 230 × 4 | 170 | 20 | 184 | 10.3 |
| 220 | | 22244CAKE4 | + AH 2244 | Tr 240 × 4 | 130 | 20 | 136 | 9.1 |
| 220 | | 23244CKE4 | + AH 2344 | Tr 240 × 4 | 181 | 30 | 189 | 13.5 |
| 220 | | 22344CAKE4 | + AH 2344 | Tr 240 × 4 | 181 | 30 | 189 | 13.5 |
| 220 | | 240 | 23048CAKE4 | + AH 3048 | Tr 260 × 4 | 116 | 21 | 123 |
| | 240 | 24048CK30E4 | + AH 24048 | Tr 250 × 4 | 138 | 20 | 153 | 9.0 |
| | 240 | 23148CKE4 | + AH 3148 | Tr 260 × 4 | 154 | 25 | 161 | 12 |
| | 240 | 24148CK30E4 | + AH 24148 | Tr 260 × 4 | 180 | 20 | 195 | 12.6 |
| | 240 | 22248CAKE4 | + AH 2248 | Tr 260 × 4 | 144 | 21 | 150 | 11 |
| | 240 | 23248CKE4 | + AH 2348 | Tr 260 × 4 | 189 | 30 | 197 | 15.5 |
| | 240 | 22348CAKE4 | + AH 2348 | Tr 260 × 4 | 189 | 30 | 197 | 15.5 |
| | 240 | 260 | 23052CAKE4 | + AH 3052 | Tr 280 × 4 | 128 | 23 | 135 |
| 260 | | 24052CAK30E4 | + AH 24052 | Tr 270 × 4 | 162 | 22 | 178 | 11.7 |
| 260 | | 23152CAKE4 | + AH 3152 | Tr 290 × 4 | 172 | 26 | 179 | 16 |
| 260 | | 24152CAK30E4 | + AH 24152 | Tr 280 × 4 | 202 | 22 | 218 | 15.5 |
| 260 | | 22252CAKE4 | + AH 2252 | Tr 290 × 4 | 155 | 23 | 161 | 14 |
| 260 | | 23252CAKE4 | + AH 2352 | Tr 290 × 4 | 205 | 30 | 213 | 19.5 |
| 260 | | 22352CAKE4 | + AH 2352 | Tr 290 × 4 | 205 | 30 | 213 | 19.5 |
| 260 | | 280 | 23056CAKE4 | + AH 3056 | Tr 300 × 4 | 131 | 24 | 139 |
| | 280 | 24056CAK30E4 | + AH 24056 | Tr 290 × 4 | 162 | 22 | 179 | 12.6 |
| | 280 | 23156CAKE4 | + AH 3156 | Tr 310 × 5 | 175 | 28 | 183 | 17.5 |
| | 280 | 24156CAK30E4 | + AH 24156 | Tr 300 × 4 | 202 | 22 | 219 | 16.8 |
| | 280 | 22256CAKE4 | + AH 2256 | Tr 310 × 5 | 155 | 24 | 163 | 15 |
| | 280 | 23256CAKE4 | + AH 2356 | Tr 310 × 5 | 212 | 30 | 220 | 21.5 |
| | 280 | 22356CAKE4 | + AH 2356 | Tr 310 × 5 | 212 | 30 | 220 | 21.5 |

RULMANLARIN ÇEKME MANŞONLARI

Mil Çapı 280 – 380 mm

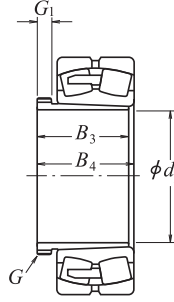

| Mil Çapı (mm) d_1 | Nominal Rulman Delik Çapı (mm) d | Nominal Numaralar | Vida Dişi G | Ölçüler (mm) | | | Kütle (kg) yaklaşık |
|---------------------------|--|-------------------------|----------------------|------------------|-------|-------|-------------------------------|
| | | | | Mevcut Rulmanlar | B_3 | G_1 | |
| 280 | 300 | 23060CAKE4 + AH 3060 | Tr 320 X 5 | 145 | 26 | 153 | 14.5 |
| | 300 | 24060CAK30E4 + AH 24060 | Tr 310 X 5 | 184 | 24 | 202 | 15.5 |
| | 300 | 23160CAKE4 + AH 3160 | Tr 330 X 5 | 192 | 30 | 200 | 21 |
| | 300 | 24160CAK30E4 + AH 24160 | Tr 320 X 5 | 224 | 24 | 242 | 20.3 |
| | 300 | 22260CAKE4 + AH 2260 | Tr 330 X 5 | 170 | 26 | 178 | 18 |
| | 300 | 23260CAKE4 + AH 3260 | Tr 330 X 5 | 228 | 34 | 236 | 20 |
| 300 | 320 | 23064CAKE4 + AH 3064 | Tr 345 X 5 | 149 | 27 | 157 | 16 |
| | 320 | 24064CAK30E4 + AH 24064 | Tr 330 X 5 | 184 | 24 | 202 | 16.4 |
| | 320 | 23164CAKE4 + AH 3164 | Tr 350 X 5 | 209 | 31 | 217 | 24.5 |
| | 320 | 24164CAK30E4 + AH 24164 | Tr 340 X 5 | 242 | 24 | 260 | 23.5 |
| | 320 | 23264CAKE4 + AH 3264 | Tr 350 X 5 | 246 | 36 | 254 | 25 |
| | 320 | 23068CAKE4 + AH 3068 | Tr 365 X 5 | 162 | 28 | 171 | 19.5 |
| 320 | 340 | 24068CAK30E4 + AH 24068 | Tr 360 X 5 | 206 | 26 | 225 | 21.2 |
| | 340 | 23168CAKE4 + AH 3168 | Tr 370 X 5 | 225 | 33 | 234 | 29 |
| | 340 | 24168CAK30E4 + AH 24168 | Tr 360 X 5 | 269 | 26 | 288 | 28.3 |
| | 340 | 23268CAKE4 + AH 3268 | Tr 370 X 5 | 264 | 38 | 273 | 35.5 |
| | 340 | 23072CAKE4 + AH 3072 | Tr 385 X 5 | 167 | 30 | 176 | 21 |
| | 340 | 24072CAK30E4 + AH 24072 | Tr 380 X 5 | 206 | 26 | 226 | 22.5 |
| 340 | 360 | 23172CAKE4 + AH 3172 | Tr 400 X 5 | 229 | 35 | 238 | 33 |
| | 360 | 24172CAK30E4 + AH 24172 | Tr 380 X 5 | 269 | 26 | 289 | 30 |
| | 360 | 23272CAKE4 + AH 3272 | Tr 400 X 5 | 274 | 40 | 283 | 41.5 |
| | 360 | 23076CAKE4 + AH 3076 | Tr 410 X 5 | 170 | 31 | 180 | 23.5 |
| | 360 | 24076CAK30E4 + AH 24076 | Tr 400 X 5 | 208 | 28 | 228 | 24.1 |
| | 360 | 23176CAKE4 + AH 3176 | Tr 420 X 5 | 232 | 36 | 242 | 35.5 |
| 360 | 380 | 24176CAK30E4 + AH 24176 | Tr 400 X 5 | 271 | 28 | 291 | 32.1 |
| | 380 | 23276CAKE4 + AH 3276 | Tr 420 X 5 | 284 | 42 | 294 | 45.5 |
| | 380 | 23080CAKE4 + AH 3080 | Tr 430 X 5 | 183 | 33 | 193 | 27.5 |
| | 380 | 24080CAK30E4 + AH 24080 | Tr 420 X 5 | 228 | 28 | 248 | 28 |
| | 380 | 23180CAKE4 + AH 3180 | Tr 440 X 5 | 240 | 38 | 250 | 39.5 |
| | 380 | 24180CAK30E4 + AH 24180 | Tr 420 X 5 | 278 | 28 | 298 | 34.8 |
| 380 | 400 | 23280CAKE4 + AH 3280 | Tr 440 X 5 | 302 | 44 | 312 | 51.5 |

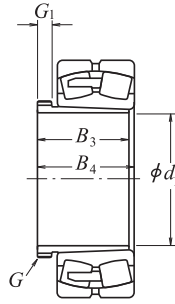

| Mil Çapı (mm) d_1 | Nominal Rulman Delik Çapı (mm) d | Nominal Numaralar | Vida Dişi | Ölçüler (mm) | | | Kütle (kg) yaklaşık |
|---------------------------|--|------------------------------------|----------------------------------|-----------------|-------|-------|---------------------------|
| | | | G | B_3 | G_1 | B_4 | |
| 400 | 420 | 23084CAKE4 + AH 3084 | Tr 450 X 5 | 186 | 34 | 196 | 29 |
| | 420 | 24084CAK30E4 + AH 24084 | Tr 440 X 5 | 230 | 30 | 252 | 29.8 |
| | 420 | 23184CAKE4 + AH 3184 | Tr 460 X 5 | 266 | 40 | 276 | 46.5 |
| | 420 | 24184CAK30E4 + AH 24184 | Tr 440 X 5 | 310 | 30 | 332 | 41.4 |
| 420 | 420 | 23284CAKE4 + AH 3284 | Tr 460 X 5 | 321 | 46 | 331 | 59 |
| | 440 | 23088CAKE4 + AHX 3088 | Tr 470 X 5 | 194 | 35 | 205 | 42 |
| | 440 | 24088CAK30E4 + AH 24088 | Tr 460 X 5 | 242 | 30 | 264 | 33 |
| | 440 | 23188CAKE4 + AHX 3188 | Tr 480 X 5 | 270 | 42 | 281 | 50 |
| | 440 | 24188CAK30E4 + AH 24188 | Tr 460 X 5 | 310 | 30 | 332 | 43.5 |
| | 440 | 23288CAKE4 + AHX 3288 | Tr 480 X 5 | 330 | 48 | 341 | 64 |
| 440 | 460 | 23092CAKE4 + AHX 3092 | Tr 490 X 5 | 202 | 37 | 213 | 46 |
| | 460 | 24092CAK30E4 + AH 24092 | Tr 480 X 5 | 250 | 32 | 273 | 35.9 |
| | 460 | 23192CAKE4 + AHX 3192 | Tr 510 X 6 | 285 | 43 | 296 | 58 |
| | 460 | 24192CAK30E4 + AH 24192 | Tr 480 X 5 | 332 | 32 | 355 | 49.7 |
| | 460 | 23292CAKE4 + AHX 3292 | Tr 510 X 6 | 349 | 50 | 360 | 74.5 |
| | 460 | 480 | 23096CAKE4 + AHX 3096 | Tr 520 X 6 | 205 | 38 | 217 |
| 480 | | 24096CAK30E4 + AH 24096 | Tr 500 X 5 | 250 | 32 | 273 | 37.5 |
| 480 | | 23196CAKE4 + AHX 3196 | Tr 530 X 6 | 295 | 45 | 307 | 63 |
| 480 | | 24196CAK30E4 + AH 24196 | Tr 500 X 5 | 340 | 32 | 363 | 53 |
| 480 | | 23296CAKE4 + AHX 3296 | Tr 530 X 6 | 364 | 52 | 376 | 82 |
| 480 | | 500 | 230/500CAKE4 + AHX 30/500 | Tr 540 X 6 | 209 | 40 | 221 |
| | 500 | 240/500CAK30E4 + AH 240/500 | Tr 530 X 6 | 253 | 35 | 276 | 41.9 |
| | 500 | 231/500CAKE4 + AHX 31/500 | Tr 550 X 6 | 313 | 47 | 325 | 71 |
| | 500 | 241/500CAK30E4 + AH 241/500 | Tr 530 X 6 | 360 | 35 | 383 | 61.2 |
| | 500 | 232/500CAKE4 + AHX 32/500 | Tr 550 X 6 | 393 | 54 | 405 | 94.5 |

RULMANLARIN SOMUNLARI

(Adaptörler ve Miller için)

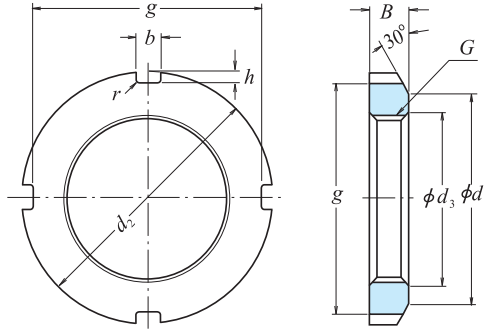

Pullu Somun

Birimler: mm

| Nominal Numaralar | Somun Serisi AN | | | | | | | | | | Referans | | |
|-------------------|-------------------|----------------|----------------|-----|----|-----|----------------|----|---------------------------|--|-------------------|-------------|-----|
| | Vida Dişleri G | Temel Ölçüler | | | | | | | Kütle (kg) yaklaşık | Adaptör (*) Manşonu Delik Çapı Numaraları | Pul Numaraları | Mil Çapı | |
| | | d ₂ | d ₁ | g | b | h | d ₃ | B | r maks. | | | | |
| AN 02 | M 15X1 | 25 | 21 | 21 | 4 | 2 | 15.5 | 5 | 0.4 | 0.010 | — | AW 02 X | 15 |
| AN 03 | M 17X1 | 28 | 24 | 24 | 4 | 2 | 17.5 | 5 | 0.4 | 0.013 | — | AW 03 X | 17 |
| AN 04 | M 20X1 | 32 | 26 | 28 | 4 | 2 | 20.5 | 6 | 0.4 | 0.019 | 04 | AW 04 X | 20 |
| AN 05 | M 25X1.5 | 38 | 32 | 34 | 5 | 2 | 25.8 | 7 | 0.4 | 0.025 | 05 | AW 05 X | 25 |
| AN 06 | M 30X1.5 | 45 | 38 | 41 | 5 | 2 | 30.8 | 7 | 0.4 | 0.043 | 06 | AW 06 X | 30 |
| AN 07 | M 35X1.5 | 52 | 44 | 48 | 5 | 2 | 35.8 | 8 | 0.4 | 0.053 | 07 | AW 07 X | 35 |
| AN 08 | M 40X1.5 | 58 | 50 | 53 | 6 | 2.5 | 40.8 | 9 | 0.5 | 0.085 | 08 | AW 08 X | 40 |
| AN 09 | M 45X1.5 | 65 | 56 | 60 | 6 | 2.5 | 45.8 | 10 | 0.5 | 0.119 | 09 | AW 09 X | 45 |
| AN 10 | M 50X1.5 | 70 | 61 | 65 | 6 | 2.5 | 50.8 | 11 | 0.5 | 0.148 | 10 | AW 10 X | 50 |
| AN 11 | M 55X2 | 75 | 67 | 69 | 7 | 3 | 56 | 11 | 0.5 | 0.158 | 11 | AW 11 X | 55 |
| AN 12 | M 60X2 | 80 | 73 | 74 | 7 | 3 | 61 | 11 | 0.5 | 0.174 | 12 | AW 12 X | 60 |
| AN 13 | M 65X2 | 85 | 79 | 79 | 7 | 3 | 66 | 12 | 0.5 | 0.203 | 13 | AW 13 X | 65 |
| AN 14 | M 70X2 | 92 | 85 | 85 | 8 | 3.5 | 71 | 12 | 0.5 | 0.242 | 14 | AW 14 X | 70 |
| AN 15 | M 75X2 | 98 | 90 | 91 | 8 | 3.5 | 76 | 13 | 0.5 | 0.287 | 15 | AW 15 X | 75 |
| AN 16 | M 80X2 | 105 | 95 | 98 | 8 | 3.5 | 81 | 15 | 0.6 | 0.395 | 16 | AW 16 X | 80 |
| AN 17 | M 85X2 | 110 | 102 | 103 | 8 | 3.5 | 86 | 16 | 0.6 | 0.45 | 17 | AW 17 X | 85 |
| AN 18 | M 90X2 | 120 | 108 | 112 | 10 | 4 | 91 | 16 | 0.6 | 0.555 | 18 | AW 18 X | 90 |
| AN 19 | M 95X2 | 125 | 113 | 117 | 10 | 4 | 96 | 17 | 0.6 | 0.66 | 19 | AW 19 X | 95 |
| AN 20 | M 100X2 | 130 | 120 | 122 | 10 | 4 | 101 | 18 | 0.6 | 0.70 | 20 | AW 20 X | 100 |
| AN 21 | M 105X2 | 140 | 126 | 130 | 12 | 5 | 106 | 18 | 0.7 | 0.845 | 21 | AW 21 X | 105 |
| AN 22 | M 110X2 | 145 | 133 | 135 | 12 | 5 | 111 | 19 | 0.7 | 0.965 | 22 | AW 22 X | 110 |
| AN 23 | M 115X2 | 150 | 137 | 140 | 12 | 5 | 116 | 19 | 0.7 | 1.01 | — | AW 23 | 115 |
| AN 24 | M 120X2 | 155 | 138 | 145 | 12 | 5 | 121 | 20 | 0.7 | 1.08 | 24 | AW 24 | 120 |
| AN 25 | M 125X2 | 160 | 148 | 150 | 12 | 5 | 126 | 21 | 0.7 | 1.19 | — | AW 25 | 125 |

Not (*) Adaptör manşonu Serisi A31, A2, A3 ve A23 için geçerlidir.

Notlar Vida dişlerinin temel tasarımı ve ölçüleri JIS B 0205'e uygundur.

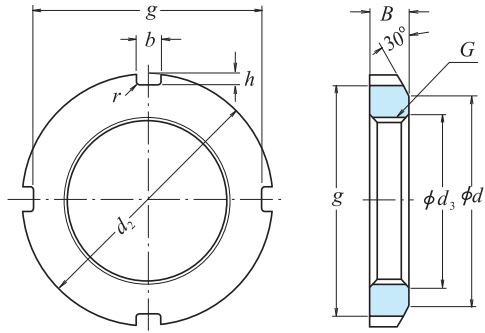

Pullu Somun

Birimler: mm

| Nominal Numaralar | Somun Serisi AN | | | | | | | | | | Referans | | |
|-------------------|--------------------------|-----------------------|-----------------------|----------|----------|----------|-----------------------|----------|------------------|---------------------------|--|-------------------|-------------|
| | Vida Dişleri <i>G</i> | <i>d</i> ₂ | <i>d</i> ₁ | <i>g</i> | <i>b</i> | <i>h</i> | <i>d</i> ₃ | <i>B</i> | <i>r</i> maks | Kütle (kg) yaklaşık | Adaptör (1) Manşonu Delik Çapı Numaraları | Pul Numaraları | Mil Çapı |
| AN 26 | M 130×2 | 165 | 149 | 155 | 12 | 5 | 131 | 21 | 0.7 | 1.25 | 26 | AW 26 | 130 |
| AN 27 | M 135×2 | 175 | 160 | 163 | 14 | 6 | 136 | 22 | 0.7 | 1.55 | — | AW 27 | 135 |
| AN 28 | M 140×2 | 180 | 160 | 168 | 14 | 6 | 141 | 22 | 0.7 | 1.56 | 28 | AW 28 | 140 |
| AN 29 | M 145×2 | 190 | 172 | 178 | 14 | 6 | 146 | 24 | 0.7 | 2.0 | — | AW 29 | 145 |
| AN 30 | M 150×2 | 195 | 171 | 183 | 14 | 6 | 151 | 24 | 0.7 | 2.03 | 30 | AW 30 | 150 |
| AN 31 | M 155×3 | 200 | 182 | 186 | 16 | 7 | 156.5 | 25 | 0.7 | 2.21 | — | — | — |
| AN 32 | M 160×3 | 210 | 182 | 196 | 16 | 7 | 161.5 | 25 | 0.7 | 2.59 | 32 | AW 32 | 160 |
| AN 33 | M 165×3 | 210 | 193 | 196 | 16 | 7 | 166.5 | 26 | 0.7 | 2.43 | — | — | — |
| AN 34 | M 170×3 | 220 | 193 | 206 | 16 | 7 | 171.5 | 26 | 0.7 | 2.8 | 34 | AW 34 | 170 |
| AN 36 | M 180×3 | 230 | 203 | 214 | 18 | 8 | 181.5 | 27 | 0.7 | 3.05 | 36 | AW 36 | 180 |
| AN 38 | M 190×3 | 240 | 214 | 224 | 18 | 8 | 191.5 | 28 | 0.7 | 3.4 | 38 | AW 38 | 190 |
| AN 40 | M 200×3 | 250 | 226 | 234 | 18 | 8 | 201.5 | 29 | 0.7 | 3.7 | 40 | AW 40 | 200 |

Somun Serisi ANL

| | | | | | | | | | | | | | |
|---------------|---------|-----|-----|-----|----|---|-------|----|-----|------|----|---------------|-----|
| ANL 24 | M 120×2 | 145 | 133 | 135 | 12 | 5 | 121 | 20 | 0.7 | 0.78 | 24 | AWL 24 | 120 |
| ANL 26 | M 130×2 | 155 | 143 | 145 | 12 | 5 | 131 | 21 | 0.7 | 0.88 | 26 | AWL 26 | 130 |
| ANL 28 | M 140×2 | 165 | 151 | 153 | 14 | 6 | 141 | 22 | 0.7 | 0.99 | 28 | AWL 28 | 140 |
| ANL 30 | M 150×2 | 180 | 164 | 168 | 14 | 6 | 151 | 24 | 0.7 | 1.38 | 30 | AWL 30 | 150 |
| ANL 32 | M 160×3 | 190 | 174 | 176 | 16 | 7 | 161.5 | 25 | 0.7 | 1.56 | 32 | AWL 32 | 160 |
| ANL 34 | M 170×3 | 200 | 184 | 186 | 16 | 7 | 171.5 | 26 | 0.7 | 1.72 | 34 | AWL 34 | 170 |
| ANL 36 | M 180×3 | 210 | 192 | 194 | 18 | 8 | 181.5 | 27 | 0.7 | 1.95 | 36 | AWL 36 | 180 |
| ANL 38 | M 190×3 | 220 | 202 | 204 | 18 | 8 | 191.5 | 28 | 0.7 | 2.08 | 38 | AWL 38 | 190 |
| ANL 40 | M 200×3 | 240 | 218 | 224 | 18 | 8 | 201.5 | 29 | 0.7 | 2.98 | 40 | AWL 40 | 200 |

Not (1) Seri AN, adaptör manşonu Serisi A31 ve A23 için geçerlidir.
Seri ANL, adaptör manşonu Serisi A30 için geçerlidir.

Notlar Vida dişlerinin temel tasarımı ve ölçüleri JIS B 0205'e uygundur.

RULMANLARIN SOMUNLARI

(Adaptörler ve Miller için)

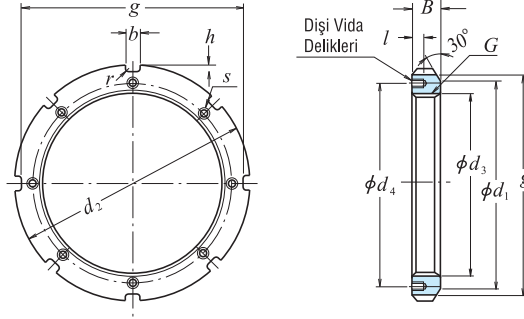

Stoperli Somun

Birimler: mm

| Nominal Numaralar | Somun Serisi AN | | | | | | | | | | Referans | | | | | |
|-------------------|-------------------|----------------|----------------|-----|----|----|---------------------|----|------------|-----|---------------------------|---|----------------------|-------------|---------------|-----|
| | Vida Dişleri G | Temel Ölçüler | | | | | Dişi Vida Delikleri | | | | Kütle (kg) yaklaşık | Adaptör (1) Maşonu Delik Çapı Numaraları | Stoper Numaraları | Mil Çapı | | |
| | | d ₂ | d ₁ | g | b | h | d ₃ | B | r maks. | l | Vida Dişleri (s) | d ₄ | | | | |
| AN 44 | Tr 220X4 | 280 | 250 | 260 | 20 | 10 | 222 | 32 | 0.8 | 15M | 8X1.25 | 238 | 5.2 | 44 | AL 44 | 220 |
| AN 48 | Tr 240X4 | 300 | 270 | 280 | 20 | 10 | 242 | 34 | 0.8 | 15M | 8X1.25 | 258 | 5.95 | 48 | AL 44 | 240 |
| AN 52 | Tr 260X4 | 330 | 300 | 306 | 24 | 12 | 262 | 36 | 0.8 | 18M | 10X1.5 | 281 | 8.05 | 52 | AL 52 | 260 |
| AN 56 | Tr 280X4 | 350 | 320 | 326 | 24 | 12 | 282 | 38 | 0.8 | 18M | 10X1.5 | 301 | 9.05 | 56 | AL 52 | 280 |
| AN 60 | Tr 300X4 | 380 | 340 | 356 | 24 | 12 | 302 | 40 | 0.8 | 18M | 10X1.5 | 326 | 11.8 | 60 | AL 60 | 300 |
| AN 64 | Tr 320X5 | 400 | 360 | 376 | 24 | 12 | 322.5 | 42 | 0.8 | 18M | 10X1.5 | 345 | 13.1 | 64 | AL 64 | 320 |
| AN 68 | Tr 340X5 | 440 | 400 | 410 | 28 | 15 | 342.5 | 55 | 1 | 21M | 12X1.75 | 372 | 23.1 | 68 | AL 68 | 340 |
| AN 72 | Tr 360X5 | 460 | 420 | 430 | 28 | 15 | 362.5 | 58 | 1 | 21M | 12X1.75 | 392 | 25.1 | 72 | AL 68 | 360 |
| AN 76 | Tr 380X5 | 490 | 450 | 454 | 32 | 18 | 382.5 | 60 | 1 | 21M | 12X1.75 | 414 | 31 | 76 | AL 76 | 380 |
| AN 80 | Tr 400X5 | 520 | 470 | 484 | 32 | 18 | 402.5 | 62 | 1 | 27M | 16X2 | 439 | 37 | 80 | AL 80 | 400 |
| AN 84 | Tr 420X5 | 540 | 490 | 504 | 32 | 18 | 422.5 | 70 | 1 | 27M | 16X2 | 459 | 43.5 | 84 | AL 80 | 420 |
| AN 88 | Tr 440X5 | 560 | 510 | 520 | 36 | 20 | 442.5 | 70 | 1 | 27M | 16X2 | 477 | 45 | 88 | AL 88 | 440 |
| AN 92 | Tr 460X5 | 580 | 540 | 540 | 36 | 20 | 462.5 | 75 | 1 | 27M | 16X2 | 497 | 50.5 | 92 | AL 88 | 460 |
| AN 96 | Tr 480X5 | 620 | 560 | 580 | 36 | 20 | 482.5 | 75 | 1 | 27M | 16X2 | 527 | 62 | 96 | AL 96 | 480 |
| AN 100 | Tr 500X5 | 630 | 580 | 584 | 40 | 23 | 502.5 | 80 | 1 | 27M | 16X2 | 539 | 63.5 | /500 | AL 100 | 500 |

Somun Serisi ANL

| | | | | | | | | | | | | | | | | |
|----------------|----------|-----|-----|-----|----|----|-------|----|-----|-----|---------|-----|------|------|---------------|-----|
| ANL 44 | Tr 220X4 | 260 | 242 | 242 | 20 | 9 | 222 | 30 | 0.8 | 12M | 6X1 | 229 | 3.1 | 44 | ALL 44 | 220 |
| ANL 48 | Tr 240X4 | 290 | 270 | 270 | 20 | 10 | 242 | 34 | 0.8 | 15M | 8X1.25 | 253 | 5.15 | 48 | ALL 48 | 240 |
| ANL 52 | Tr 260X4 | 310 | 290 | 290 | 20 | 10 | 262 | 34 | 0.8 | 15M | 8X1.25 | 273 | 5.65 | 52 | ALL 48 | 260 |
| ANL 56 | Tr 280X4 | 330 | 310 | 310 | 24 | 10 | 282 | 38 | 0.8 | 15M | 8X1.25 | 293 | 6.8 | 56 | ALL 56 | 280 |
| ANL 60 | Tr 300X4 | 360 | 336 | 336 | 24 | 12 | 302 | 42 | 0.8 | 15M | 8X1.25 | 316 | 9.6 | 60 | ALL 60 | 300 |
| ANL 64 | Tr 320X5 | 380 | 356 | 356 | 24 | 12 | 322.5 | 42 | 0.8 | 15M | 8X1.25 | 335 | 9.95 | 64 | ALL 64 | 320 |
| ANL 68 | Tr 340X5 | 400 | 376 | 376 | 24 | 12 | 342.5 | 45 | 1 | 15M | 8X1.25 | 355 | 11.7 | 68 | ALL 64 | 340 |
| ANL 72 | Tr 360X5 | 420 | 394 | 394 | 28 | 13 | 362.5 | 45 | 1 | 15M | 8X1.25 | 374 | 12 | 72 | ALL 72 | 360 |
| ANL 76 | Tr 380X5 | 450 | 422 | 422 | 28 | 14 | 382.5 | 48 | 1 | 18M | 10X1.5 | 398 | 14.9 | 76 | ALL 76 | 380 |
| ANL 80 | Tr 400X5 | 470 | 442 | 442 | 28 | 14 | 402.5 | 52 | 1 | 18M | 10X1.5 | 418 | 16.9 | 80 | ALL 76 | 400 |
| ANL 84 | Tr 420X5 | 490 | 462 | 462 | 32 | 14 | 422.5 | 52 | 1 | 18M | 10X1.5 | 438 | 17.4 | 84 | ALL 84 | 420 |
| ANL 88 | Tr 440X5 | 520 | 490 | 490 | 32 | 15 | 442.5 | 60 | 1 | 21M | 12X1.75 | 462 | 26.2 | 88 | ALL 88 | 440 |
| ANL 92 | Tr 460X5 | 540 | 510 | 510 | 32 | 15 | 462.5 | 60 | 1 | 21M | 12X1.75 | 482 | 28 | 92 | ALL 88 | 460 |
| ANL 96 | Tr 480X5 | 560 | 530 | 530 | 36 | 15 | 482.5 | 60 | 1 | 21M | 12X1.75 | 502 | 29.5 | 96 | ALL 96 | 480 |
| ANL 100 | Tr 500X5 | 580 | 550 | 550 | 36 | 15 | 502.5 | 68 | 1 | 21M | 12X1.75 | 522 | 33.5 | /500 | ALL 96 | 500 |

Not (1) Seri AN, adaptör maşonu Serisi A31, A32 ve A23 için geçerlidir.

Seri ANL, adaptör maşonu Serisi A30 için geçerlidir.

- Notlar
1. Vida dişlerinin temel tasarımı ve ölçüleri JIS B 0216.'ya uygundur.
 2. Vida dişlerinin temel tasarımı ve ölçüleri JIS B 0205 'e uygundur.

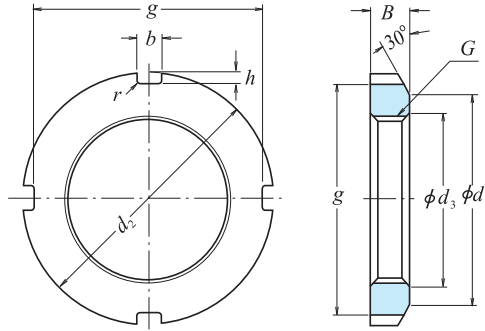
(Çekme Manşonları için)

Birimler: mm

| Nominal Numaralar | Somun Serisi HN | | | | | | | | | Referans | | | | |
|-------------------|-------------------|----------------|----------------|-----|----|----|----------------|----|---------------------------|--------------------------|------------------|----------------|------------------|----------------|
| | Vida Dişleri G | Temel Ebatlar | | | | | | | Kütle (kg) yaklaşık | Çekme Manşonu Numaraları | | | | |
| | | d ₂ | d ₁ | g | b | h | d ₃ | B | | r maks. | AH 31 | AH 22 | AH 32 | AH 23 |
| HN 42 | Tr 210X4 | 270 | 238 | 250 | 20 | 10 | 212 | 30 | 0.8 | 4.75 | AH 3138 | AH 2238 | AH 3238 | AH 2338 |
| HN 44 | Tr 220X4 | 280 | 250 | 260 | 20 | 10 | 222 | 32 | 0.8 | 5.35 | AH 3140 | AH 2240 | AH 3240 | AH 2340 |
| HN 48 | Tr 240X4 | 300 | 270 | 280 | 20 | 10 | 242 | 34 | 0.8 | 6.2 | AH 3144 | AH 2244 | — | AH 2344 |
| HN 52 | Tr 260X4 | 330 | 300 | 306 | 24 | 12 | 262 | 36 | 0.8 | 8.55 | AH 3148 | AH 2248 | — | AH 2348 |
| HN 58 | Tr 290X4 | 370 | 330 | 346 | 24 | 12 | 292 | 40 | 0.8 | 11.8 | AH 3152 | AH 2252 | — | AH 2352 |
| HN 62 | Tr 310X5 | 390 | 350 | 366 | 24 | 12 | 312.5 | 42 | 0.8 | 13.4 | AH 3156 | AH 2256 | — | AH 2356 |
| HN 66 | Tr 330X5 | 420 | 380 | 390 | 28 | 15 | 332.5 | 52 | 1 | 20.4 | AH 3160 | AH 2260 | AH 3260 | — |
| HN 70 | Tr 350X5 | 450 | 410 | 420 | 28 | 15 | 352.5 | 55 | 1 | 25.2 | AH 3164 | AH 2264 | AH 3264 | — |
| HN 74 | Tr 370X5 | 470 | 430 | 440 | 28 | 15 | 372.5 | 58 | 1 | 28.2 | AH 3168 | — | AH 3268 | — |
| HN 80 | Tr 400X5 | 520 | 470 | 484 | 32 | 18 | 402.5 | 62 | 1 | 40 | AH 3172 | — | AH 3272 | — |
| HN 84 | Tr 420X5 | 540 | 490 | 504 | 32 | 18 | 422.5 | 70 | 1 | 46.9 | AH 3176 | — | AH 3276 | — |
| HN 88 | Tr 440X5 | 560 | 510 | 520 | 36 | 20 | 442.5 | 70 | 1 | 48.5 | AH 3180 | — | AH 3280 | — |
| HN 92 | Tr 460X5 | 580 | 540 | 540 | 36 | 20 | 462.5 | 75 | 1 | 55 | AH 3184 | — | AH 3284 | — |
| HN 96 | Tr 480X5 | 620 | 560 | 580 | 36 | 20 | 482.5 | 75 | 1 | 67 | AHX 3188 | — | AHX 3288 | — |
| HN 102 | Tr 510X6 | 650 | 590 | 604 | 40 | 23 | 513 | 80 | 1 | 75 | AHX 3192 | — | AHX 3292 | — |
| HN 106 | Tr 530X6 | 670 | 610 | 624 | 40 | 23 | 533 | 80 | 1 | 78 | AHX 3196 | — | AHX 3296 | — |
| HN 110 | Tr 550X6 | 700 | 640 | 654 | 40 | 23 | 553 | 80 | 1 | 92.5 | AHX 31500 | — | AHX 32500 | — |
| Somun Serisi HNL | | | | | | | | | AH 30 | AH 2 | | | | |
| HNL 41 | Tr 205X4 | 250 | 232 | 234 | 18 | 8 | 207 | 30 | 0.8 | 3.45 | AH 3038 | AH 238 | | |
| HNL 43 | Tr 215X4 | 260 | 242 | 242 | 20 | 9 | 217 | 30 | 0.8 | 3.7 | AH 3040 | AH 240 | | |
| HNL 47 | Tr 235X4 | 280 | 262 | 262 | 20 | 9 | 237 | 34 | 0.8 | 4.6 | AH 3044 | AH 244 | | |
| HNL 52 | Tr 260X4 | 310 | 290 | 290 | 20 | 10 | 262 | 34 | 0.8 | 5.8 | AH 3048 | AH 248 | | |
| HNL 56 | Tr 280X4 | 330 | 310 | 310 | 24 | 10 | 282 | 38 | 0.8 | 6.7 | AH 3052 | AH 252 | | |
| HNL 60 | Tr 300X4 | 360 | 336 | 336 | 24 | 12 | 302 | 42 | 0.8 | 9.6 | AH 3056 | AH 256 | | |
| HNL 64 | Tr 320X5 | 380 | 356 | 356 | 24 | 12 | 322.5 | 42 | 1 | 10.3 | AH 3060 | — | | |
| HNL 69 | Tr 345X5 | 410 | 384 | 384 | 28 | 13 | 347.5 | 45 | 1 | 11.5 | AH 3064 | — | | |
| HNL 73 | Tr 365X5 | 430 | 404 | 404 | 28 | 13 | 367.5 | 48 | 1 | 14.2 | AH 3068 | — | | |
| HNL 77 | Tr 385X5 | 450 | 422 | 422 | 28 | 14 | 387.5 | 48 | 1 | 15 | AH 3072 | — | | |
| HNL 82 | Tr 410X5 | 480 | 452 | 452 | 32 | 14 | 412.5 | 52 | 1 | 19 | AH 3076 | — | | |
| HNL 86 | Tr 430X5 | 500 | 472 | 472 | 32 | 14 | 432.5 | 52 | 1 | 19.8 | AH 3080 | — | | |
| HNL 90 | Tr 450X5 | 520 | 490 | 490 | 32 | 15 | 452.5 | 60 | 1 | 23.8 | AH 3084 | — | | |
| HNL 94 | Tr 470X5 | 540 | 510 | 510 | 32 | 15 | 472.5 | 60 | 1 | 25 | AHX 3088 | — | | |
| HNL 98 | Tr 490X5 | 580 | 550 | 550 | 36 | 15 | 492.5 | 60 | 1 | 34 | AHX 3092 | — | | |
| HNL 104 | Tr 520X6 | 600 | 570 | 570 | 36 | 15 | 523 | 68 | 1 | 37 | AHX 3096 | — | | |
| HNL 108 | Tr 540X6 | 630 | 590 | 590 | 40 | 20 | 543 | 68 | 1 | 43.5 | AHX 30500 | — | | |

Notlar

- Vida dişlerinin temel tasarımı ve ölçüleri JIS B 0216'ya uygundur.
- Somundaki çentik sayısı, yukarıdaki şekilde gösterilenden daha büyük olabilir.

RULMANLARIN SOMUNLARI

(Çekme Manşonu ve Somun Kombinasyonları)

| Nominal Numaralar | Referans | | | | | | |
|-------------------|--------------------------|----------|--------|---------|----------|---------|----------|
| | Çekme Manşonu Numaraları | | | | | | |
| | AH 30 | AH 31 | AH 2 | AH 22 | AH 32 | AH 3 | AH 23 |
| AN 09 | — | — | AH 208 | — | — | AH 308 | AH 2308 |
| AN 10 | — | — | AH 209 | — | — | AH 309 | AH 2309 |
| AN 11 | — | — | AH 210 | — | — | AHX 310 | AHX 2310 |
| AN 12 | — | — | AH 211 | — | — | AHX 311 | AHX 2311 |
| AN 13 | — | — | AH 212 | — | — | AHX 312 | AHX 2312 |
| AN 14 | — | — | — | — | — | — | — |
| AN 15 | — | — | AH 213 | — | — | AH 313 | AH 2313 |
| AN 16 | — | — | AH 214 | — | — | AH 314 | AHX 2314 |
| AN 17 | — | — | AH 215 | — | — | AH 315 | AHX 2315 |
| AN 18 | — | — | AH 216 | — | — | AH 316 | AHX 2316 |
| AN 19 | — | — | AH 217 | — | — | AHX 317 | AHX 2317 |
| AN 20 | — | — | AH 218 | — | AHX 3218 | AHX 318 | AHX 2318 |
| AN 21 | — | — | AH 219 | — | — | AHX 319 | AHX 2319 |
| AN 22 | — | — | AH 220 | — | AHX 3220 | AHX 320 | AHX 2320 |
| AN 23 | — | — | AH 221 | — | — | AHX 321 | — |
| AN 24 | — | AHX 3122 | AH 222 | — | — | AHX 322 | — |
| AN 25 | — | — | — | — | AHX 3222 | — | AHX 2322 |
| AN 26 | AHX 3024 | AHX 3124 | AH 224 | — | — | AHX 324 | — |
| AN 27 | — | — | — | — | AHX 3224 | — | AHX 2324 |
| AN 28 | AHX 3026 | AHX 3126 | AH 226 | — | — | AHX 326 | — |
| AN 29 | — | — | — | — | AHX 3226 | — | AHX 2326 |
| AN 30 | AHX 3028 | AHX 3128 | AH 228 | — | — | AHX 328 | — |
| AN 31 | — | — | — | — | AHX 3228 | — | AHX 2328 |
| AN 32 | AHX 3030 | — | AH 230 | — | — | — | — |
| AN 33 | — | AHX 3130 | — | — | AHX 3230 | AHX 330 | AHX 2330 |
| AN 34 | AH 3032 | — | AH 232 | — | — | — | — |
| AN 36 | AH 3034 | AH 3132 | AH 234 | — | AH 3232 | AH 332 | AH 2332 |
| AN 38 | AH 3036 | AH 3134 | AH 236 | — | AH 3234 | AH 334 | AH 2334 |
| AN 40 | — | AH 3136 | — | AH 2236 | AH 3236 | — | AH 2336 |

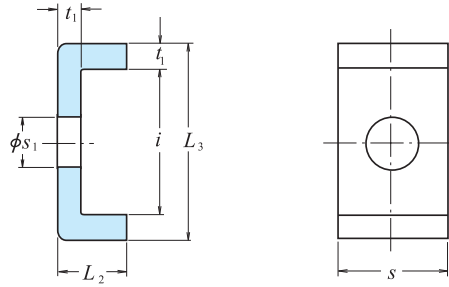

Birimler: mm

| Nominal Numaralar | Stoper Serisi AL | | | | | | 100 parça başına düşen kütle (kg) yaklaşık | Referans |
|--------------------------|------------------|-----|-------|-------|------|------------------|--|---|
| | Temel Ebatlar | | | | | Somun Numaraları | | |
| | t_1 | S | L_2 | s_1 | i | L_3 | | |
| AL 44 | 4 | 20 | 12 | 9 | 22.5 | 30.5 | 2.6 | AN 44, AN 48 AN 52, AN 56 AN 60 |
| AL 52 | 4 | 24 | 12 | 12 | 25.5 | 33.5 | 3.4 | |
| AL 60 | 4 | 24 | 12 | 12 | 30.5 | 38.5 | 3.8 | |
| AL 64 | 5 | 24 | 15 | 12 | 31 | 41 | 5.35 | AN 64 AN 68, AN 72 AN 76 |
| AL 68 | 5 | 28 | 15 | 14 | 38 | 48 | 6.65 | |
| AL 76 | 5 | 32 | 15 | 14 | 40 | 50 | 7.95 | |
| AL 80 | 5 | 32 | 15 | 18 | 45 | 55 | 8.2 | AN 80, AN 84 AN 88, AN 92 AN 96 AN 100 |
| AL 88 | 5 | 36 | 15 | 18 | 43 | 53 | 9.0 | |
| AL 96 | 5 | 36 | 15 | 18 | 53 | 63 | 10.4 | |
| AL 100 | 5 | 40 | 15 | 18 | 45 | 55 | 10.5 | |
| Stoper Serisi ALL | | | | | | | | |
| ALL 44 | 4 | 20 | 12 | 7 | 13.5 | 21.5 | 2.12 | ANL 44 ANL 48, ANL 52 ANL 56 |
| ALL 48 | 4 | 20 | 12 | 9 | 17.5 | 25.5 | 2.29 | |
| ALL 56 | 4 | 24 | 12 | 9 | 17.5 | 25.5 | 2.92 | |
| ALL 60 | 4 | 24 | 12 | 9 | 20.5 | 28.5 | 3.15 | ANL 60 ANL 64, ANL 68 ANL 72 |
| ALL 64 | 5 | 24 | 15 | 9 | 21 | 31 | 4.55 | |
| ALL 72 | 5 | 28 | 15 | 9 | 20 | 30 | 5.05 | |
| ALL 76 | 5 | 28 | 15 | 12 | 24 | 34 | 5.3 | ANL 76, ANL 80 ANL 84 ANL 88, ANL 92 ANL 96, ANL 100 |
| ALL 84 | 5 | 32 | 15 | 12 | 24 | 34 | 6.1 | |
| ALL 88 | 5 | 32 | 15 | 14 | 28 | 38 | 6.45 | |
| ALL 96 | 5 | 36 | 15 | 14 | 28 | 38 | 7.3 | |

RULMANLARIN PULLARI

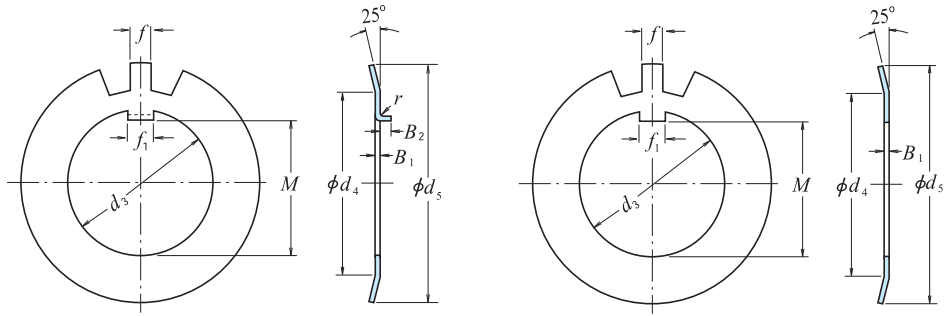

Bükülmüş Tırnak

Düz Tırnak

Birimler: mm

| Nominal Numaralar | | Pul Serisi AW | | | | | | | | | | Referans | | | |
|-------------------|------------|---------------|-------|-------|-------|-----|-------|-------|---------------------|------------|--|---|------------------|----------|-------|
| Bükülmüş Tırnak | Düz Tırnak | Temel Ebatlar | | | | | | | | Dış Sayısı | 100 parça başına düşen kütle (kg) yaklaşık | Adaptör (1) Manşonu Delik Çapı Numaraları | Somun Numaraları | Mil Çapı | |
| | | d_3 | M | f_1 | B_1 | f | d_4 | d_5 | Bükülmüş Tırnak r | | | | | | B_2 |
| AW 02 | AW 02 X | 15 | 13.5 | 4 | 1 | 4 | 21 | 28 | 1 | 2.5 | 13 | 0.253 | — | AN 02 | 15 |
| AW 03 | AW 03 X | 17 | 15.5 | 4 | 1 | 4 | 24 | 32 | 1 | 2.5 | 13 | 0.315 | — | AN 03 | 17 |
| AW 04 | AW 04 X | 20 | 18.5 | 4 | 1 | 4 | 26 | 36 | 1 | 2.5 | 13 | 0.35 | 04 | AN 04 | 20 |
| AW 05 | AW 05 X | 25 | 23 | 5 | 1.2 | 5 | 32 | 42 | 1 | 2.5 | 13 | 0.64 | 05 | AN 05 | 25 |
| AW 06 | AW 06 X | 30 | 27.5 | 5 | 1.2 | 5 | 38 | 49 | 1 | 2.5 | 13 | 0.78 | 06 | AN 06 | 30 |
| AW 07 | AW 07 X | 35 | 32.5 | 6 | 1.2 | 5 | 44 | 57 | 1 | 2.5 | 15 | 1.04 | 07 | AN 07 | 35 |
| AW 08 | AW 08 X | 40 | 37.5 | 6 | 1.2 | 6 | 50 | 62 | 1 | 2.5 | 15 | 1.23 | 08 | AN 08 | 40 |
| AW 09 | AW 09 X | 45 | 42.5 | 6 | 1.2 | 6 | 56 | 69 | 1 | 2.5 | 17 | 1.52 | 09 | AN 09 | 45 |
| AW 10 | AW 10 X | 50 | 47.5 | 6 | 1.2 | 6 | 61 | 74 | 1 | 2.5 | 17 | 1.6 | 10 | AN 10 | 50 |
| AW 11 | AW 11 X | 55 | 52.5 | 8 | 1.2 | 7 | 67 | 81 | 1 | 4 | 17 | 1.96 | 11 | AN 11 | 55 |
| AW 12 | AW 12 X | 60 | 57.5 | 8 | 1.5 | 7 | 73 | 86 | 1.2 | 4 | 17 | 2.53 | 12 | AN 12 | 60 |
| AW 13 | AW 13 X | 65 | 62.5 | 8 | 1.5 | 7 | 79 | 92 | 1.2 | 4 | 19 | 2.9 | 13 | AN 13 | 65 |
| AW 14 | AW 14 X | 70 | 66.5 | 8 | 1.5 | 8 | 85 | 98 | 1.2 | 4 | 19 | 3.35 | 14 | AN 14 | 70 |
| AW 15 | AW 15 X | 75 | 71.5 | 8 | 1.5 | 8 | 90 | 104 | 1.2 | 4 | 19 | 3.55 | 15 | AN 15 | 75 |
| AW 16 | AW 16 X | 80 | 76.5 | 10 | 1.8 | 8 | 95 | 112 | 1.2 | 4 | 19 | 4.65 | 16 | AN 16 | 80 |
| AW 17 | AW 17 X | 85 | 81.5 | 10 | 1.8 | 8 | 102 | 119 | 1.2 | 4 | 19 | 5.25 | 17 | AN 17 | 85 |
| AW 18 | AW 18 X | 90 | 86.5 | 10 | 1.8 | 10 | 108 | 126 | 1.2 | 4 | 19 | 6.25 | 18 | AN 18 | 90 |
| AW 19 | AW 19 X | 95 | 91.5 | 10 | 1.8 | 10 | 113 | 133 | 1.2 | 4 | 19 | 6.7 | 19 | AN 19 | 95 |
| AW 20 | AW 20 X | 100 | 96.5 | 12 | 1.8 | 10 | 120 | 142 | 1.2 | 6 | 19 | 7.65 | 20 | AN 20 | 100 |
| AW 21 | AW 21 X | 105 | 100.5 | 12 | 1.8 | 12 | 126 | 145 | 1.2 | 6 | 19 | 8.25 | 21 | AN 21 | 105 |
| AW 22 | AW 22 X | 110 | 105.5 | 12 | 1.8 | 12 | 133 | 154 | 1.2 | 6 | 19 | 9.4 | 22 | AN 22 | 110 |
| AW 23 | AW 23 X | 115 | 110.5 | 12 | 2 | 12 | 137 | 159 | 1.5 | 6 | 19 | 10.8 | — | AN 23 | 115 |
| AW 24 | AW 24 X | 120 | 115 | 14 | 2 | 12 | 138 | 164 | 1.5 | 6 | 19 | 10.5 | 24 | AN 24 | 120 |
| AW 25 | AW 25 X | 125 | 120 | 14 | 2 | 12 | 148 | 170 | 1.5 | 6 | 19 | 11.8 | — | AN 25 | 125 |

Not (1) Adaptör manşonu Serisi A31, A2, A3 ve A23 için geçerlidir.

Notlar Düz tırnaklı pullar, dar yarıkli adaptör manşonlarını kullanır; geniş yarıkli olanlar içinse, her iki tip pul da kullanılabilir.

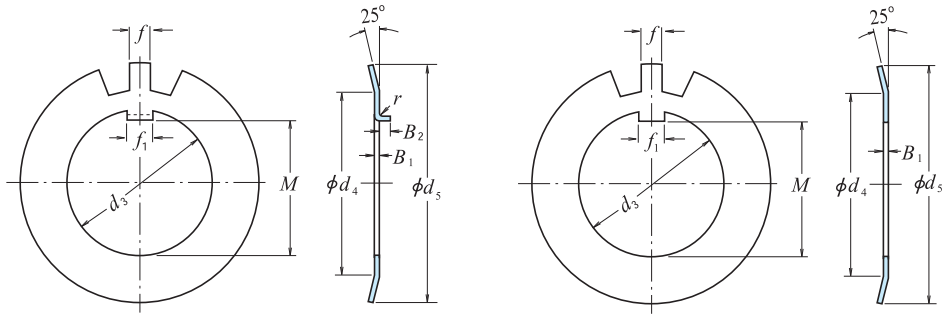

Bükülmüş Tırnak

Düz Tırnak

Birimler: mm

| Nominal Numaralar | | Pul Serisi AW | | | | | | | | | | Referans | | | | |
|-----------------------|-----------------|---------------|-------|-------|-------|-----|-------|-------|---------------------|------------|-------|--|--|------------------|----------|--|
| Bükülmüş Tırnak | Düz Tırnak | Temel Ebatlar | | | | | | | | | | 100 parça başına düşen kütle (kg) yaklaşık | Adaptör ⁽¹⁾ Manşonu Delik Çapı Numaraları | Somun Numaraları | Mil Çapı | |
| | | d_3 | M | f_1 | B_1 | f | d_4 | d_5 | Bükülmüş Tırnak r | Dış Sayısı | B_2 | | | | | |
| AW 26 | AW 26 X | 130 | 125 | 14 | 2 | 12 | 149 | 175 | 1.5 | 6 | 19 | 11.3 | 26 | AN 26 | 130 | |
| AW 27 | AW 27 X | 135 | 130 | 14 | 2 | 14 | 160 | 185 | 1.5 | 6 | 19 | 14.4 | — | AN 27 | 135 | |
| AW 28 | AW 28 X | 140 | 135 | 16 | 2 | 14 | 160 | 192 | 1.5 | 8 | 19 | 14.2 | 28 | AN 28 | 140 | |
| AW 29 | AW 29 X | 145 | 140 | 16 | 2 | 14 | 172 | 202 | 1.5 | 8 | 19 | 16.8 | — | AN 29 | 145 | |
| AW 30 | AW 30 X | 150 | 145 | 16 | 2 | 14 | 171 | 205 | 1.5 | 8 | 19 | 15.9 | 30 | AN 30 | 150 | |
| AW 31 | AW 31 X | 155 | 147.5 | 16 | 2.5 | 16 | 182 | 212 | 1.5 | 8 | 19 | 20.9 | — | AN 31 | 155 | |
| AW 32 | AW 32 X | 160 | 154 | 18 | 2.5 | 16 | 182 | 217 | 1.5 | 8 | 19 | 22.2 | 32 | AN 32 | 160 | |
| AW 33 | AW 33 X | 165 | 157.5 | 18 | 2.5 | 16 | 193 | 222 | 1.5 | 8 | 19 | 24.1 | — | AN 33 | 165 | |
| AW 34 | AW 34 X | 170 | 164 | 18 | 2.5 | 16 | 193 | 232 | 1.5 | 8 | 19 | 24.7 | 34 | AN 34 | 170 | |
| AW 36 | AW 36 X | 180 | 174 | 20 | 2.5 | 18 | 203 | 242 | 1.5 | 8 | 19 | 26.8 | 36 | AN 36 | 180 | |
| AW 38 | AW 38 X | 190 | 184 | 20 | 2.5 | 18 | 214 | 252 | 1.5 | 8 | 19 | 27.8 | 38 | AN 38 | 190 | |
| AW 40 | AW 40 X | 200 | 194 | 20 | 2.5 | 18 | 226 | 262 | 1.5 | 8 | 19 | 29.3 | 40 | AN 40 | 200 | |
| Pul Serisi AWL | | | | | | | | | | | | | | | | |
| AWL 24 | AWL 24 X | 120 | 115 | 14 | 2 | 12 | 133 | 155 | 1.5 | 6 | 19 | 7.7 | 24 | ANL 24 | 120 | |
| AWL 26 | AWL 26 X | 130 | 125 | 14 | 2 | 12 | 143 | 165 | 1.5 | 6 | 19 | 8.7 | 26 | ANL 26 | 130 | |
| AWL 28 | AWL 28 X | 140 | 135 | 16 | 2 | 14 | 151 | 175 | 1.5 | 8 | 19 | 10.9 | 28 | ANL 28 | 140 | |
| AWL 30 | AWL 30 X | 150 | 145 | 16 | 2 | 14 | 164 | 190 | 1.5 | 8 | 19 | 11.3 | 30 | ANL 30 | 150 | |
| AWL 32 | AWL 32 X | 160 | 154 | 18 | 2.5 | 16 | 174 | 200 | 1.5 | 8 | 19 | 16.2 | 32 | ANL 32 | 160 | |
| AWL 34 | AWL 34 X | 170 | 164 | 18 | 2.5 | 16 | 184 | 210 | 1.5 | 8 | 19 | 19 | 34 | ANL 34 | 170 | |
| AWL 36 | AWL 36 X | 180 | 174 | 20 | 2.5 | 18 | 192 | 220 | 1.5 | 8 | 19 | 18 | 36 | ANL 36 | 180 | |
| AWL 38 | AWL 38 X | 190 | 184 | 20 | 2.5 | 18 | 202 | 230 | 1.5 | 8 | 19 | 20.5 | 38 | ANL 38 | 190 | |
| AWL 40 | AWL 40 X | 200 | 194 | 20 | 2.5 | 18 | 218 | 250 | 1.5 | 8 | 19 | 21.4 | 40 | ANL 40 | 200 | |

Not (1) Seri AW, adaptör manşonu Serisi A31 ve A23 için geçerlidir.

Seri AWL, adaptör manşonu Serisi A30 için geçerlidir.

Notlar Düz tırnaklı pullar, dar yarıklı adaptör manşonlarını kullanır; geniş yarıklı olanlar içinse, her iki tip pul da kullanılabilir.